

SYMBOL LEGEND	
●	PROPERTY CORNER
●	POWER POLE
W	WATER METER
G	GAS METER
T	TELEPHONE PED

SET= 5/8 INCH IRON ROD WITH CAP STAMPED "BOURLAND SURVEYING"

NOTES:

1. THE SURVEY HAS BEEN COMPLETED WITHOUT THE BENEFIT OF A TITLE COMMITMENT, NO ABSTRACTING WAS COMPLETED BY THE SURVEYOR WITH REGARD TO ANY RECORDED EASEMENTS, RIGHTS-OF-WAY OR SETBACKS AFFECTING THE SUBJECT PROPERTY. NO ADDITIONAL RESEARCH REGARDING THE EXISTENCE OF EASEMENTS, RESTRICTIONS, OR OTHER MATTERS OF RECORD HAS BEEN PERFORMED BY THE SURVEYOR.
2. THIS SURVEY DOES NOT PROVIDE A DETERMINATION OR OPINION CONCERNING THE LOCATION OR EXISTENCE OF WETLANDS, FAULT LINES, TOXIC OR HAZARDOUS WASTE AREAS, SUBSIDENCE, OVERHEAD, SUBSURFACE AND ENVIRONMENTAL CONDITIONS OR GEOLOGICAL ISSUES. NO STATEMENT IS MADE CONCERNING THE SUITABILITY OF THE SUBJECT TRACT FOR ANY INTENDED USE, PURPOSE OR DEVELOPMENT.
3. DATE OF SURVEY 08/18/22
4. BASIS OF BEARING IS BASED ON RECORDED DEED IN VOLUME 6, PAGE 51 OF THE PLAT RECORDS OF SAN JACINTO COUNTY, TEXAS.
5. THERE MAY BE EASEMENTS, SETBACKS AND OTHER BUILDING RESTRICTIONS SET FORTH IN THE DEED RESTRICTIONS NOT SHOWN HEREON. IT IS THE OWNERS RESPONSIBILITY TO ENSURE THAT ALL RESTRICTIONS ARE SATISFIED PRIOR TO BUILDING.

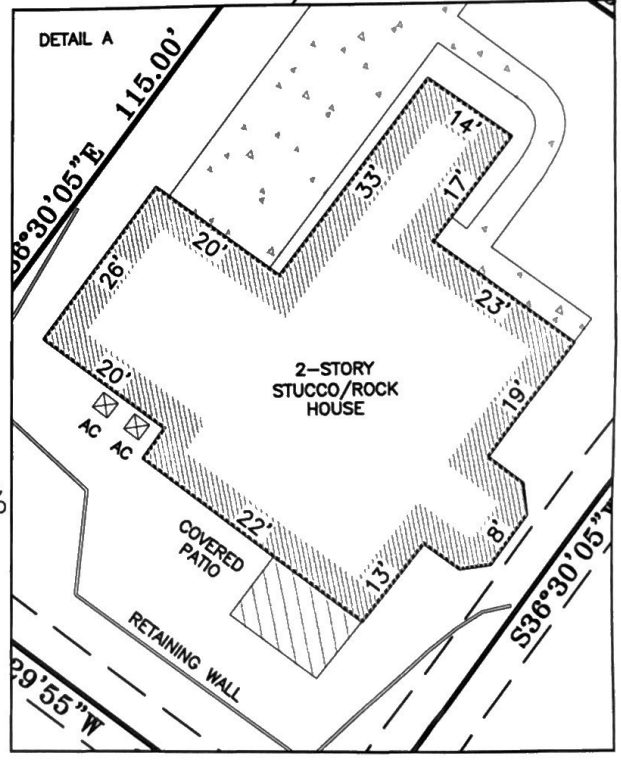

BEING LOT SIX (6), BLOCK (2), CAPE ROYALE IMPERIAL ESTATES SECTION, A SUBDIVISION IN SAN JACINTO COUNTY, TEXAS, AS SHOWN BY THE MAP OR PLAT THEREOF RECORDED IN VOLUME 6, PAGE 51 OF THE PLAT RECORDS OF SAN JACINTO COUNTY, TEXAS

THIS SURVEY SUBSTANTIALLY COMPLIES WITH THE CURRENT TEXAS SOCIETY OF PROFESSIONAL SURVEYORS STANDARDS AND SPECIFICATIONS FOR A CATEGORY 1B, CONDITION III SURVEY.

Brian K. Lunell

BRIAN K. LUNELL
REGISTERED PROFESSIONAL LAND SURVEYOR
NO. 5954 - STATE OF TEXAS

08/29/2022
DATE



**BOURLAND
LAND SURVEYING, LLC**

15121 HIGHWAY 150
COLDSPRING, TX 77331
(936)653-2264

TBPLS FIRM REG # 10194525
PROJECT NO. 22350