

NOTES: 1.) FENCES AS SHOWN.

LOT		BLOCK	SUBDIVISION	SECTION
LOT 1 AND PART OF LOT 2		3	CHAMPION FOREST	2
COUNTY	STATE	RECORDED	SURVEY	
HARRIS	TEXAS	VOL. 259, PG. 67 H.C.D.R.	SEE METES & BOUNDS ATTACHED	
ADDRESS	19 267 SALMON LANE			
PURCHASER	CLYDE R. HEBERT & JANET G. HEBERT			

**American Surveying Company
of Houston, Inc.**
2200 W. Loop South, Suite 600
Houston, Texas 77027
(713) 871-0094

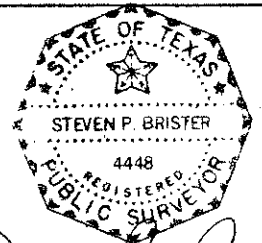

Subject Property IS NOT Located in a Federal Insurance Administration designated Flood Hazard Area
As per map 480287
Panel 0160E Dated 2-4-88

DATE 2-6-90
TITLE CO. COMMONWEALTH
G.F.# 9011039
J.O.# 20006090

Steven P. Brister

I do hereby certify that this survey was this day made on the ground of the property legally described hereon, (or on the attached sheet), and is correct, and there are no encroachments unless shown.

	DATE	BY
FIELD WORK	2-6-90	MK
DRAFTING	2-7-90	C.V.
FINAL CHECK		
KEY MAP LOCATION	3305-T	

SKETCH ADDENDUM

Borrower or Owner **Clyde & Janet Hebert**

Property Address **16267 Salmon Lane**

City **Spring** County **Harris** State **TX** Zip Code **77379**

Client **Clyde & Janet Hebert**

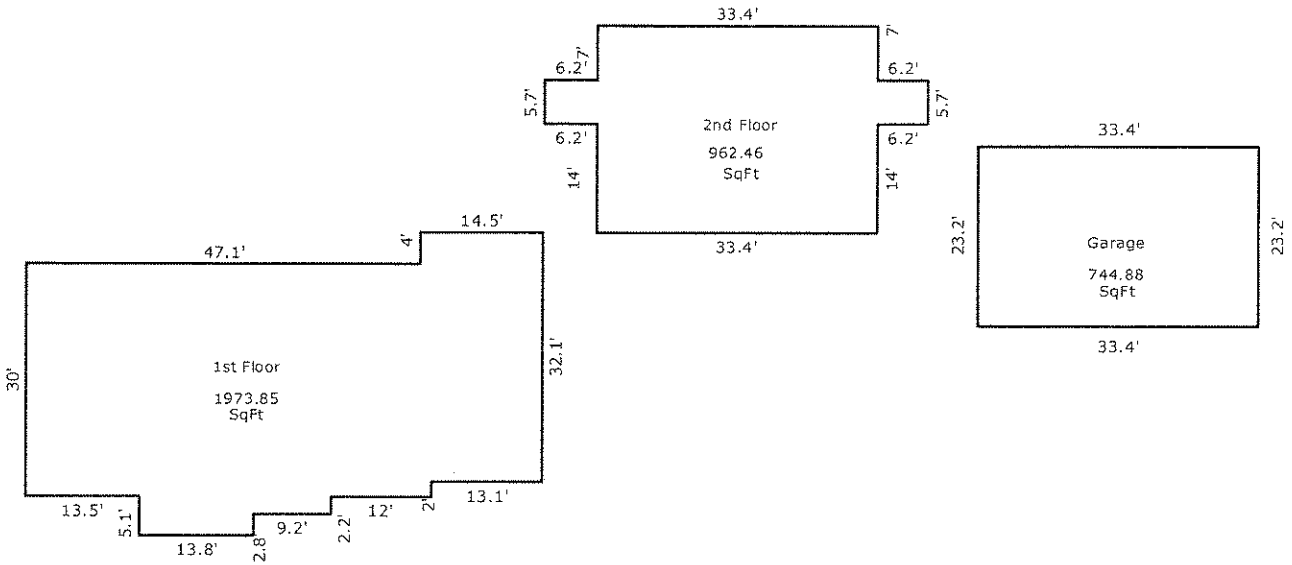

Sketch by Apex Sketch v5 Standard™

Comments:

AREA CALCULATIONS SUMMARY			
Code	Description	Net Size	Net Totals
GLA1	First Floor	1973.85	1973.85
GLA2	Second Floor	962.46	962.46
GAR	Garage	774.88	774.88
Net LIVABLE Area		(rounded)	2936

LIVING AREA BREAKDOWN		
	Breakdown	Subtotals
First Floor		
	48.5 x 1.9	92.15
	0.1 x 35.0	3.50
	61.6 x 28.1	1730.96
	2.8 x 13.8	38.64
	2.2 x 23.0	50.60
	4.0 x 14.5	58.00
Second Floor		
	0.5 x 33.4	0.00
	14.0 x 33.4	467.60
	45.8 x 5.7	261.06
	0.5 x 14.0	0.00
	7.0 x 33.4	233.80
11 Items	(rounded)	2936