

MONTGOMERY CAMPGROUND RESORT

PROPOSED COMMERCIAL DEVELOPMENT
MONTGOMERY COUNTY, TEXAS
9367 F.M. 149 - MONTGOMERY, TEXAS 77316

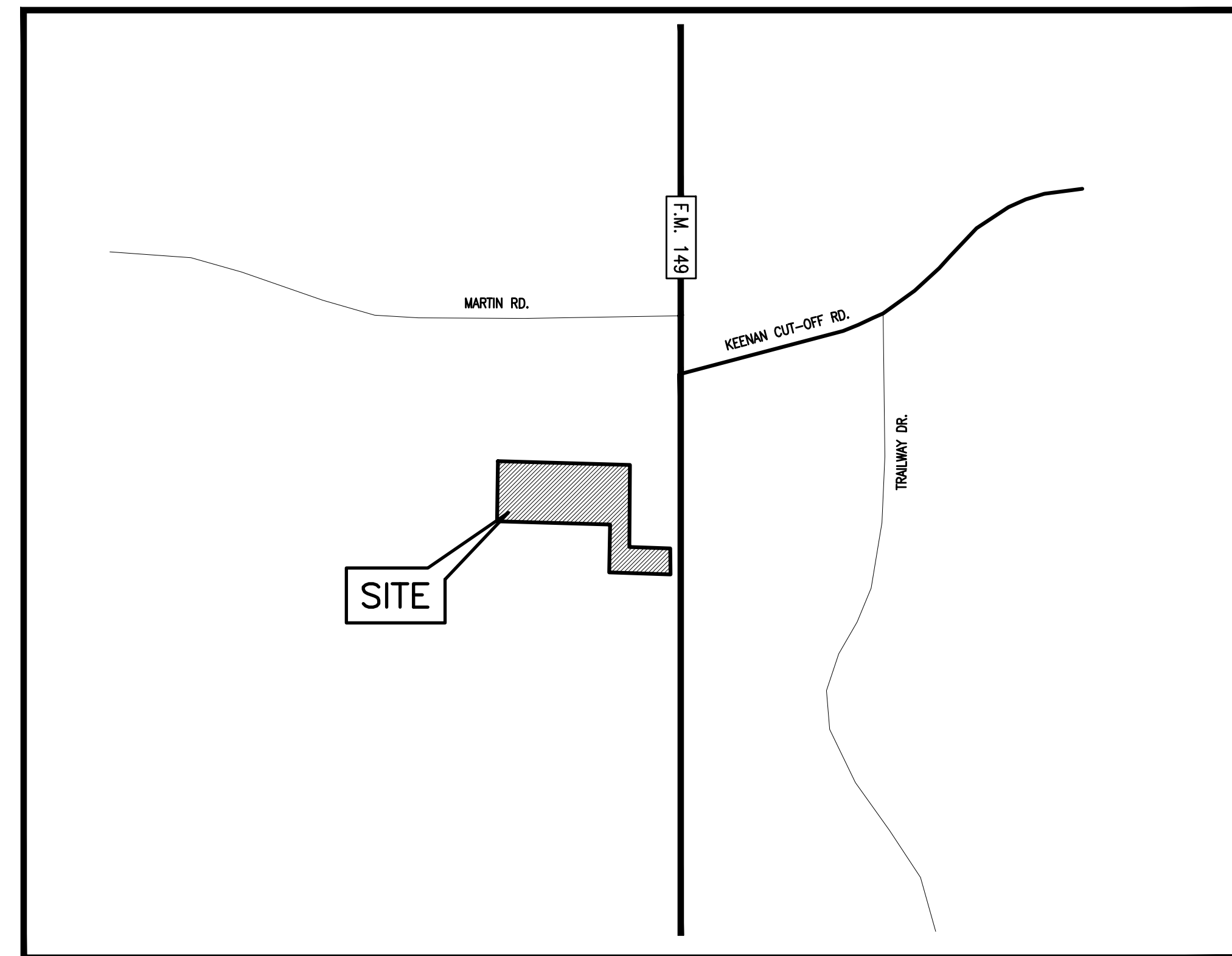

VICINITY MAP

SHEET INDEX

1. COVER SHEET
2. GENERAL NOTES
3. TOPOGRAPHIC SURVEY
4. DRAINAGE AREA MAP (EXISTING)
5. DRAINAGE CALCS (PROPOSED)
6. DRAINAGE PLAN
7. DETENTION POND DETAILS
8. SWPPP
9. SWPPP DETAILS
10. STORM SEWER DETAILS

SEPTEMBER 2022

PREPARED BY:

AES SEPTIC, LLC
30703 N. CRIPPLE CREEK DR.
MAGNOLIA, TX 77354
PH. (281) 766-7442
FAX. (281) 259-3799

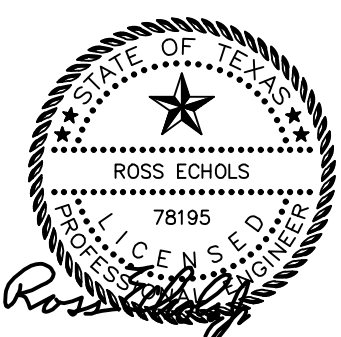

AUTHORIZED SIGNATURE BY
ROSS L. ECHOLS, P.E. ON
September 28, 2022

