

### Building Sketch

Borrower				
Property Address 665 County Road 1270				
City	Warren	County	State TX	Zip Code 77664
Lender/Client				

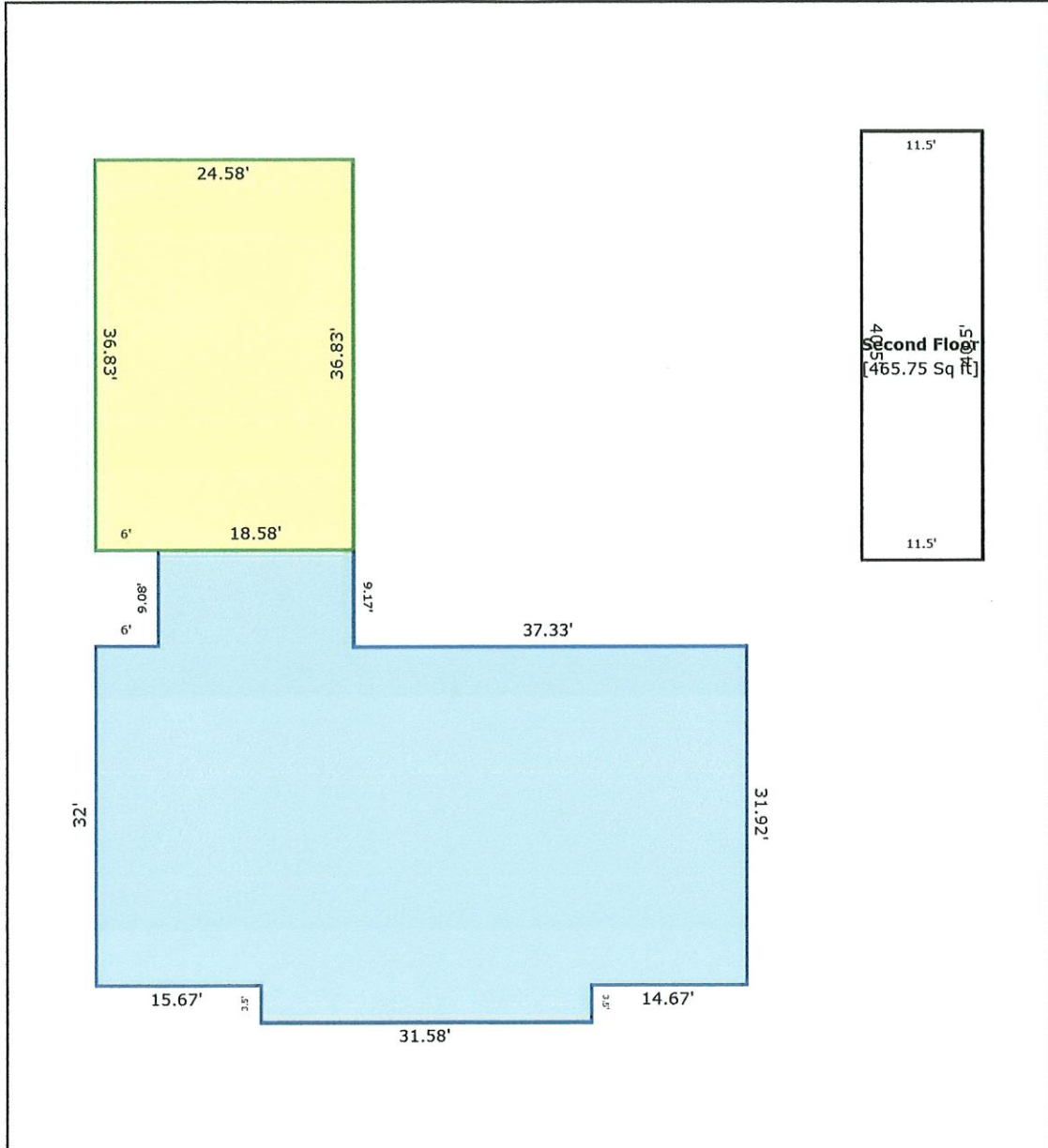

TOTAL Sketch by a la mode, inc.

Area Calculations Summary		Calculation Details	
<b>Living Area</b>			
First Floor	2257.56 Sq ft	31.58 × 3.5 =	110.54
		61.92 × 31.92 =	1976.18
		9.17 × 18.58 =	170.35
		0.08 × 6 =	0.5
Second Floor	465.75 Sq ft	11.5 × 40.5 =	465.75
<b>Total Living Area (Rounded):</b>	<b>2723 Sq ft</b>		
<b>Non-living Area</b>			
3 Car Attached	905.49 Sq ft	36.83 × 24.58 =	905.48