

Building Sketch (Page - 1)

| | | | | | |
|------------------|---------|--------------------|--------|-------|----|
| Borrower | | | | | |
| Property Address | | 702 Huntercrest St | | | |
| City | El Lago | County | Harris | State | TX |
| | | Zip Code | 77586 | | |
| Lender/Client | | | | | |

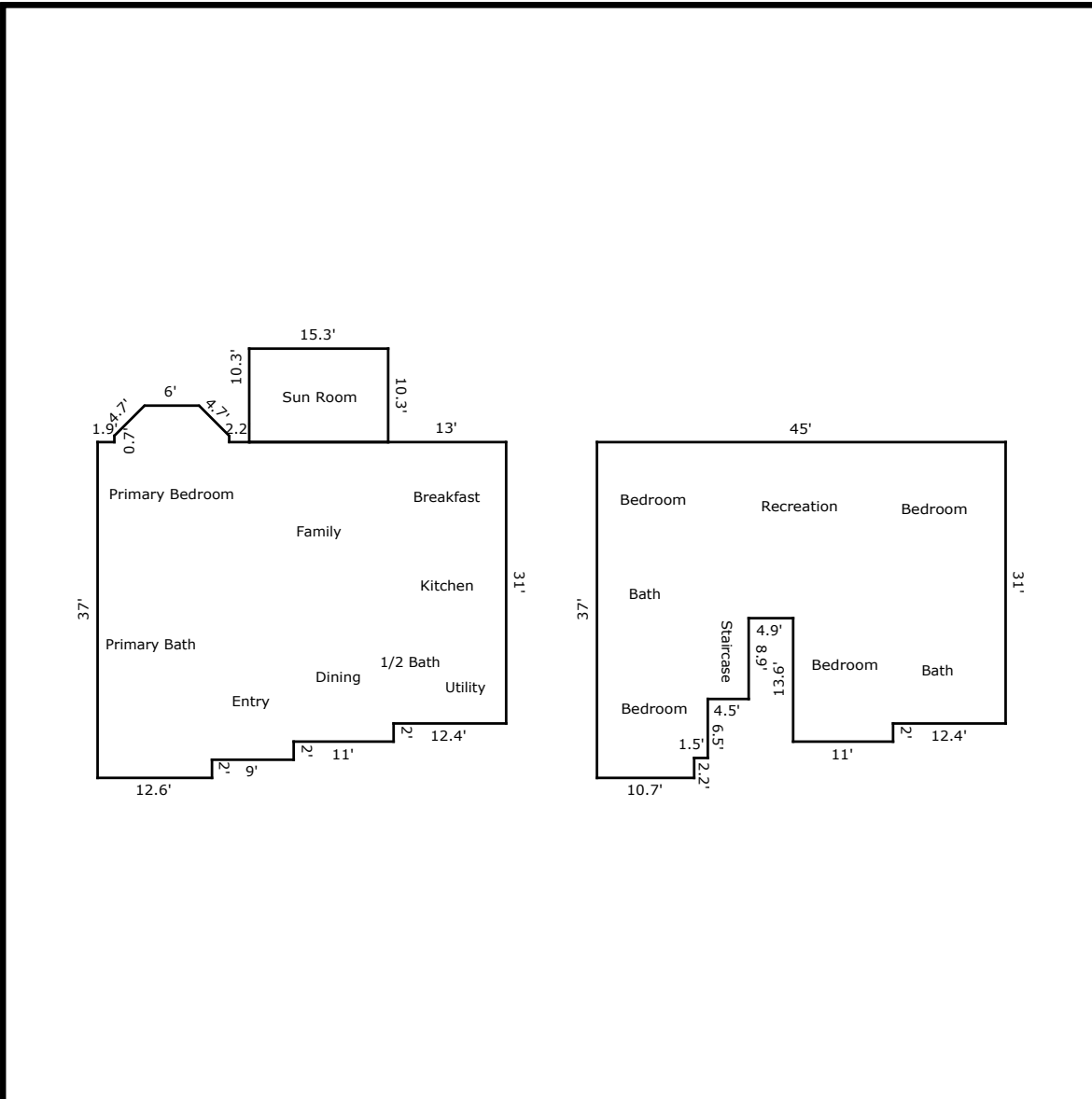

TOTAL Sketch by a la mode

Area Calculations Summary

| Living Area | Calculation Details | |
|-------------------------------------|---------------------|---|
| First Floor | 1568.4 Sq ft | $12.6 \times 2 = 25.2$ $21.6 \times 2 = 43.2$ $32.6 \times 2 = 65.2$ $45 \times 31 = 1395$ $12.6 \times 0.7 = 8.9$ $0.5 \times 3.3 \times 3.3 = 5.5$ $0.5 \times 3.3 \times 3.3 = 5.5$ $6 \times 3.3 = 19.9$ |
| Second Floor | 1417.9 Sq ft | $45 \times 19.4 = 873$ $11.6 \times 12.4 = 143.8$ $11 \times 13.6 = 149.6$ $17.6 \times 10.7 = 188.3$ $6 \times 8.9 = 53.4$ $1.5 \times 6.5 = 9.8$ |
| Total Living Area (Rounded): | 2986 Sq ft | |
| Non-living Area | | |
| Closed Porch | 157.6 Sq ft | $10.3 \times 15.3 = 157.6$ |

Building Sketch (Page - 2)

| | | | | | |
|------------------|---------|--------------------|--------|-------|----|
| Borrower | | | | | |
| Property Address | | 702 Huntercrest St | | | |
| City | El Lago | County | Harris | State | TX |
| | | Zip Code | 77586 | | |
| Lender/Client | | | | | |

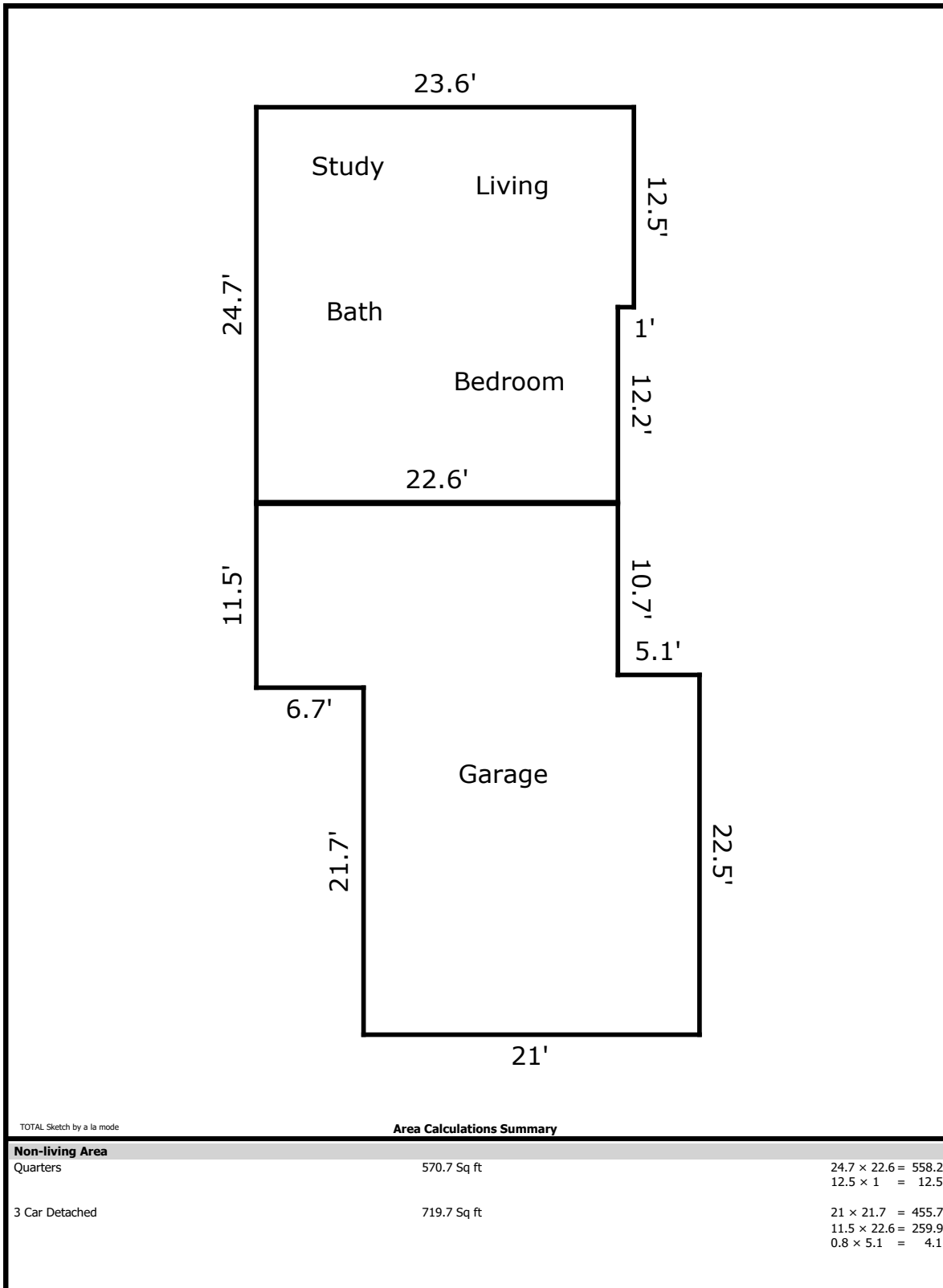

TOTAL Sketch by a la mode

Area Calculations Summary

| Non-living Area | | |
|-----------------|-------------|--|
| Quarters | 570.7 Sq ft | $24.7 \times 22.6 = 558.2$ $12.5 \times 1 = 12.5$ |
| 3 Car Detached | 719.7 Sq ft | $21 \times 21.7 = 455.7$ $11.5 \times 22.6 = 259.9$ $0.8 \times 5.1 = 4.1$ |

Certification

RUSSELL WAYNE TUCKER
307 PINEVIEW CIR
EL LAGO, TX 77586



Certified Residential Real Estate Appraiser

Appraiser: **RUSSELL WAYNE TUCKER**

License #: **TX 1360082 R**

License Expires: **12/31/2027**

Having provided satisfactory evidence of the qualifications required by the Texas Appraiser Licensing and Certification Act, Occupations Code, Chapter 1103, authorization is granted to use this title:
Certified Residential Real Estate Appraiser

For additional information or to file a complaint please contact TALCB at www.talcb.texas.gov.

A handwritten signature in blue ink that reads 'Chelsea Buchholtz'.

Chelsea Buchholtz
Executive Director