

25 0 25 50 75 FEET

SCALE: 1"=25'

GLADSTELL RD.

N 74°01'25" E  
126.76'

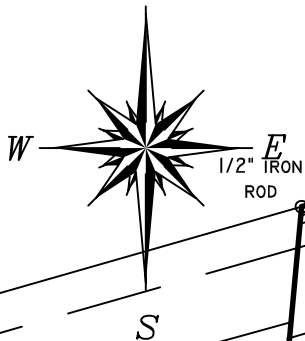

AS PER PLAT

S 00°55'16" E

117.25'

50' DRAINAGE ESMT

0.388  
AC

(SEE ATTACHED  
M&B)

RIVERSHIRE  
SEC 1  
BLK 1

25

N 05°14'20" E  
116.69'

CALLED 0.2106A  
K RODNEY  
2020033493

SEE BDY LNE  
AGRMT OF RECORD  
2000-076207  
(INTENDED TO CURE  
DRIVE ENCROACHMENTS)

CONCRETE  
DRIVE

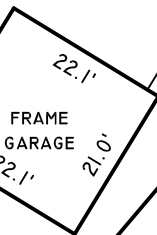

24

1 STORY  
BRICK  
RESIDENCE

COVD  
PATIO

POOL

ADD'N  
TO  
RES

NEW FENCE

1/2" IRON  
ROD

OLD "X"  
IN CONC  
ORIG COR  
1/2" IR  
1.9' N36W  
(APPARENT  
ERROR BY  
SRVYR AUG 2000

N 56°54'02" W  
R=50.00'  
ARC L:45.66'

SURVEY FOR:  
JEFFREY SCOTT TUCKER  
& LYNETTE MARIE TUCKER  
8 CAMBRIDGE CIRCLE  
CONROE, TEXAS 77304

BEING A PORTION OF LOT 24, BLOCK I, RIVERSHIRE  
SECTION I, A SUBDIVISION IN MONTGOMERY COUNTY,  
TEXAS, ACCORDING TO THE MAP OR PLAT THEREOF  
RECORDED IN CABINET A, SHEET 65 OF THE MAP  
RECORDS OF MONTGOMERY COUNTY, TEXAS.

936 856 8989  
PROJECT NO. 535321

POINT OF  
BEGINNING

S 59°16'26" W  
113.39'  
BASIS FOR BRGS. CALL: 114.09'

23

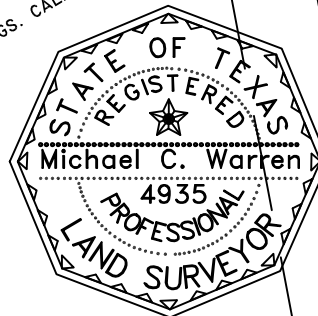

I HEREBY CERTIFY THAT THIS SURVEY WAS MADE ON THE GROUND OF  
THE PROPERTY LEGALLY DESCRIBED HEREON, AND CONTAINS NO  
DISCREPANCIES, SHORTAGES IN AREA, BOUNDARY LINE OR OTHER  
CONFLICTS, ENCROACHMENTS, OVERLAPPING OF IMPROVEMENTS,  
EASEMENTS OR RIGHTS-OF-WAY EXCEPT AS SHOWN, AND HAS ACCESS  
TO AND FROM A DEDICATED ROADWAY.

DATE OF SURVEY: 01 NOVEMBER 2021 (01 JULY 02')

MICHAEL C. WARREN  
REGISTERED PROFESSIONAL LAND SURVEYOR No. 4935