

SCALE: 1" = 70'

LEGEND

- C.I.R. = CAPPED IRON ROD
 - CVRD. = COVERED AREA
 - E.M. = ELECTRICAL METER
 - F.C.I.R. = FOUND CAPPED IRON ROD
 - F.I.P. = FOUND IRON PIPE
 - F.I.R. = FOUND IRON ROD
 - M.R. = COUNTY MAP RECORDS
 - P.R. = PLAT RECORDS
 - U.P. = UTILITY POLE
 - R.D.W. = RIGHT-OF-WAY
 - W.M. = WATER METER
-
- AC AIR CONDITIONER UNIT
 - IP IRON PIPE
 - IR IRON ROD
 - GM GAS METER
 - GW GUY WIRE
 - PP POWER POLE
 - UP UTILITY POLE
 - WM WATER METER
 - WOOD FENCE
 - CHAINLINK FENCE
 - WROUGHT IRON FENCE
 - BARB WIRE FENCE
 - METAL FENCE
 - HIGH BANK
 - ADJOINING PROPERTY
 - SUBJECT TRACT
 - EXISTING PAVEMENT
 - COVERED AREA
 - STRUCTURE / BUILDING

NOTES:

- Survey bases on the best field evidence found.
- Bearings shown hereon are based on the control monuments depicted within the survey.
- Property subject to other subdivision covenants, conditions & restrictions be easements, building lines and other matters of record.

ABSTRACTING NOTE:

Survey was performed without the benefit of a current Title Report at the client's request. There may be other easements and encumbrances that affect Subject property that are not shown.

BOUNDARY SURVEY

**LOT 20, OF BLOCK 3, OF RIVERSIDE OIL FIELD,
AN ADDITION LOCATED IN THE JOHN BROWN
JONES 1/3rd LEAGUE, HARRIS COUNTY, TEXAS,
ACCORDING TO THE MAP OR PLAT THEREOF
RECORDED IN VOL. 154, PG. 279, H.C.D.R.**

Date: 07/02/2025
Field Work: ML
Drawn By: MAL
Project No.: R2025-019

Project Location:
Potts Road,
Humble, TX 77338

FLOOD DATA

THIS PROPERTY IS IN THE 100 YEAR FLOOD ZONE,
IS IN ZONE AE PER FIRM MAP, COMMUNITY PANEL
No. 48201C0295M WHICH HAS AN EFFECTIVE DATE
OF 06/09/2014, AND IS IN THE SPECIAL FLOOD
HAZARD AREA.

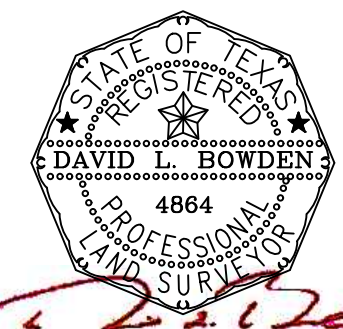

TBPLS Firm Registration No. 10127400

©COPYRIGHT 2025 BOWDEN SURVEY CO.
SURVEY is good for this transaction only.
Copying or unauthorized use of this SURVEY not only violates federal and state copyright laws, punishable by CIVIL and CRIMINAL sanctions, but is OUTRIGHT THEFT and harms Bowden Survey Co.'s livelihood. Please don't do it.

Bowden Survey
Professional Surveying Services
bowdensurvey.com
Phone: (281) 531-1900
Fax: (281) 531-4900