

Building Sketch

Borrower	Trust International Holdings LLC			
Property Address	301 Vincent St			
City	Houston	County Harris	State TX	Zip Code 77009
Lender/Client	Trident Realty Investments, LLC			

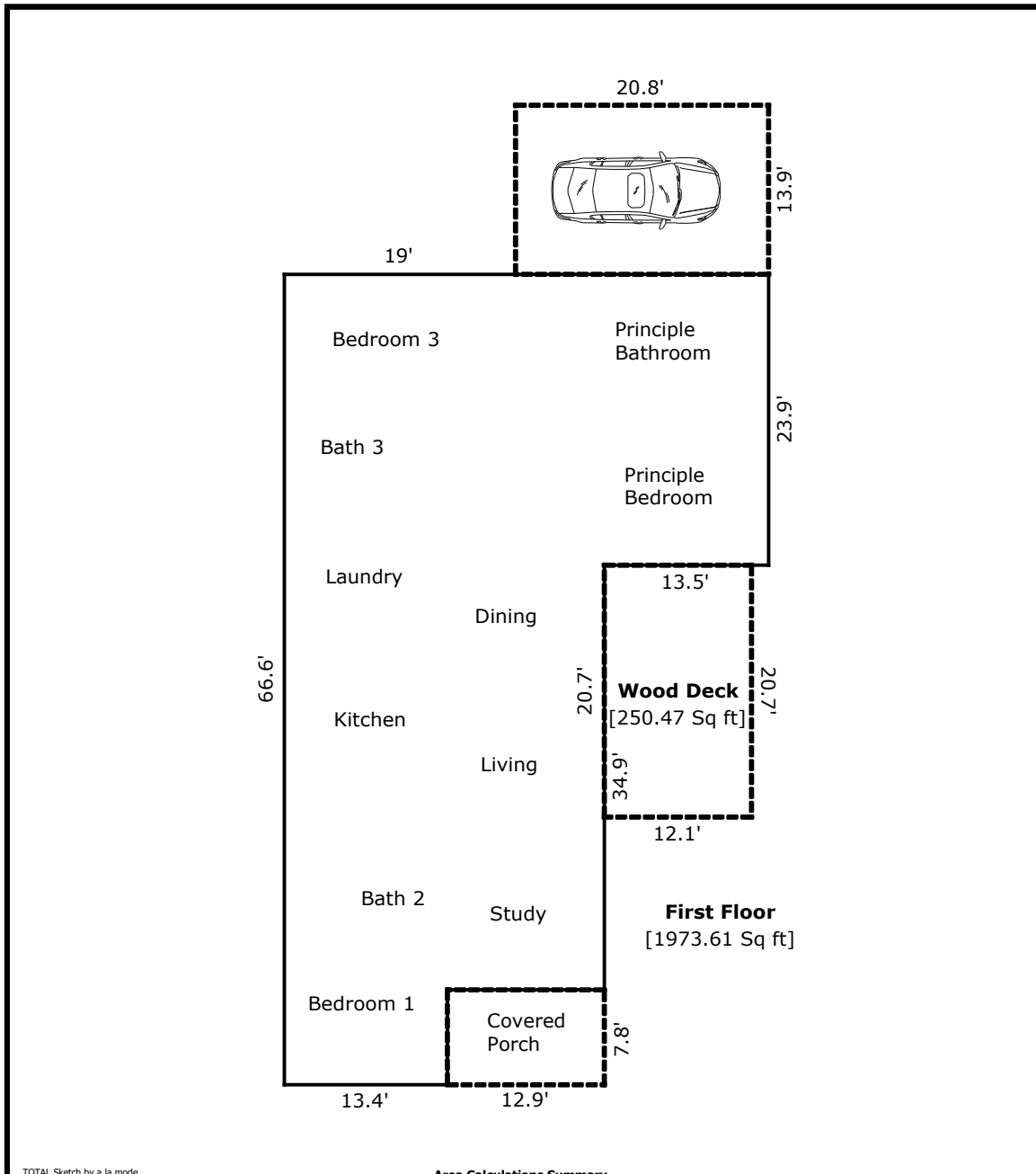

TOTAL Sketch by a la mode

Area Calculations Summary

Living Area	Calculation Details	
First Floor	1973.61 Sq ft	39.8 × 23.9 = 951.22 26.3 × 34.9 = 917.87 7.8 × 13.4 = 104.52
Total Living Area (Rounded):	1974 Sq ft	
Non-living Area		
Wood Deck	250.47 Sq ft	12.1 × 20.7 = 250.47
Covered Porch	100.62 Sq ft	7.8 × 12.9 = 100.62
1 Car Attached	289.12 Sq ft	13.9 × 20.8 = 289.12 0.5 × 13.9 × 0 = 0