

NOTES:

- 1.) SUBJECT TO ANY AND ALL RESTRICTIVE COVENANTS IN VOLUME 293, PAGE 120 H.C.M.R. AND H.C.C.F. NOS. F-476736, F-642997, F-813757, G-446729, G-465347, G-686028, H-278911, M-484533 AND P-403830.
- 2.) H.L.& P. AGREEMENT BY H.C.C.F. NO. G-424219.
- 3.) CATY AGREEMENT BY H.C.C.F. NO. G-286014.
- 4.) A.C. INTO THE BENT, AS SHOWN

THE SURVEYOR HAS NOT ABSTRACTED THE SUBJECT PROPERTY.
 SUBJECT PROPERTY IS BASED ON TITLE COMMITMENT LISTED BELOW.
 ALL BEARINGS SHOWN ARE REFERENCED PER RECORDED PLAT OF SAID SUBDIVISION.

LOT	BLOCK	SUBDIVISION	SECTION
27	14	WINGATE	2
COUNTY	STATE	RECORDED	SURVEY
HARRIS	TEXAS	VOLUME 293, PAGE 120 H.C.M.R.	SCALE: 1"=20'
PURCHASER: HOLLY A. HEDGES			ADDRESS: 8919 VINEYARD DRIVE, HOUSTON, TEXAS 77082



REALTY INFORMATION SERVICES

REAL ESTATE SURVEY DIVISION
 4650 PORT OAK PLACE DRIVE
 SUITE 015
 HOUSTON, TEXAS 77027
 TEL: (713) 439-0900
 FAX: (713) 571-1288

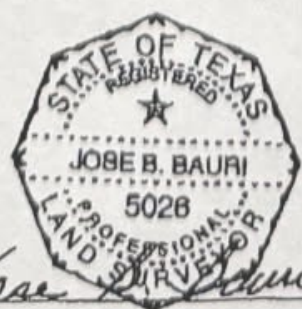

I HEREBY CERTIFY THAT THIS SURVEY WAS THIS DAY MADE ON THE GROUND ON THE PROPERTY LOGICALLY DESCRIBED HEREON IS CORRECT, AND THERE ARE NO ENCROACHMENTS EXCEPT AS SHOWN HEREON.

• Subject Property IS NOT Located in a Federal Insurance Administration Designated Flood Hazard Area. ZONE 'X'
 As per map 480257
 Filed 0270 H Dated SEPT. 30, 1992

• THIS INFORMATION IS BASED ON GRAPHIC PLOTTING ONLY. WE DO NOT ASSUME RESPONSIBILITY FOR EXACT DIMENSIONALIZATION.

	DATED	BY
FIELD WORK	12-19-93	T.S.
DRAFTING	12-19-93	V.T.
FINAL CHECK	12-19-93	
KEY MAP	527 C	

MORT. CO.	CHASE MANHATTAN
TITLE CO.	CHICAGO TITLE CO.
Q.P. NO.	187394
JOB NO.	86 - 15774
REV. DATE	-