

“THE CRAWFORD”

28502 Crawford Ridge Ct
Huffman, TX 77336



- Built in 2015 | Elara Custom Homes | Completed in 2016
- One Story Home | 4,392 sq ft | 1.035 Acre Lot (end of cul-de-sac)
- 4 Bedrooms | 3.5 Bathrooms
 - Casita (4th bedroom), Living Room, Bath with Shower
- Formal Dining | Media Room/Game Room
- Study with Glass Doors & Wood Cabinetry | Pocket Office by Kitchen
- 3 Car Attached Garage, 32' Wide X 23' Deep, 8' High Overhead Doors
- Bonus Room with Mini Split HVAC (Great for Exercise Room or Crafts)
- Spray Foam Insulation in Attic | Full Carpeted Stairway Access to Attic
- Insulated Workshop (16' x 20') with Window AC & Electricity
- Brick & Stone Exterior with Breezeway Between House & Garage
- Back Covered Patio with Vaulted Ceiling
- Heated Gunite Pool & Spa (15,000 gallons) - 2016 (5 ½ ft Depth)
- Whole House Generac Generator 26 KW - 2023
- Lawn Irrigation System | 2nd Water Meter for Discounted Water Rate
- Fenced Backyard | Flagstone Path to Green House
- Tray Ceilings with Crown Molding | 8' Doors Throughout
- Stunning Wood & Travertine Tile Flooring
- Granite Counters | Custom Cabinets Throughout, Large Island Kitchen with Prep Sink, Pot Filler, Touch Faucets, Luxury Kitchen Aid Appliances, Slide Out Spice Racks, Lighted Glass Display Cabinets to Ceiling, Tray Ceiling
- Walk-in Kitchen Pantry & Walk-in Butler's Pantry
- Gas Fireplace Logs in Living Room
- Spacious Bedrooms with Walk-in Closets
- Stunning Primary Bathroom with Custom Cabinets, Dual Vanities, Travertine Flooring, Walkthrough Shower with Multi-Heads & Rain Head, Jetted Tub, 2 Walk-in Closets, Linen Closet
- Laundry Room with Sink, Custom Cabinets, Blanket Closet
- Community Lakeside Parks for Fishing, Boating | Miles of Hiking Trails
- Community Pool & Pavilion | Wildlife throughout Community

“THE CRAWFORD”

28502 Crawford Ridge Ct
Huffman, TX 77336



A Private Estate Where Elegance Meets Nature

Welcome to an extraordinary one story custom residence set on 1.035 acres in the prestigious Commons of Lake Houston. Surrounded by towering trees and tranquil natural beauty, this 4,392-square-foot estate offers a rare blend of refined luxury and peaceful country living.

From the moment you enter, timeless craftsmanship is on display—rich wood and travertine floors, plantation shutters, soaring ceilings, and stately 8-foot doors create a warm yet sophisticated ambiance. The grand living room is both inviting and impressive, centered around a stone-accented fireplace, custom-built cabinetry, and a beautifully illuminated tray ceiling overlooking the resort-style backyard.

At the heart of the home lies a truly exceptional chef’s kitchen. Thoughtfully designed for both everyday living and elegant entertaining, it features a statement island with prep sink, granite surfaces, premium appliances, custom cabinetry with lighted glass displays, butler’s pantry, and a charming wine bar—every detail curated to inspire.

The private primary suite offers a serene retreat with its own sitting area and direct access to the outdoor oasis. The spa-inspired bath invites relaxation with a jetted soaking tub, walk-through multi-head shower, dual vanities, and luxurious finishes throughout.

A casita provides a private living space with a full bath—ideal for guests or multigenerational living. Additional spaces include a formal dining room, private study, convenient second office near the kitchen overlooking the pool, media/game room, and a versatile climate-controlled bonus room for crafts or exercising.

Outdoors, experience true resort living with a heated pool and spa, covered patio, whole house generator, greenhouse, and workshop—all designed for both relaxation and recreation.

Residents enjoy exclusive access to lakes, trails, and community amenities, while remaining conveniently close to Houston, IAH, and premier shopping and dining.

Sophisticated. Private. Unforgettable.
This is more than a home—it’s a lifestyle.

“THE CRAWFORD”

28502 Crawford Ridge Ct
Huffman, TX 77336

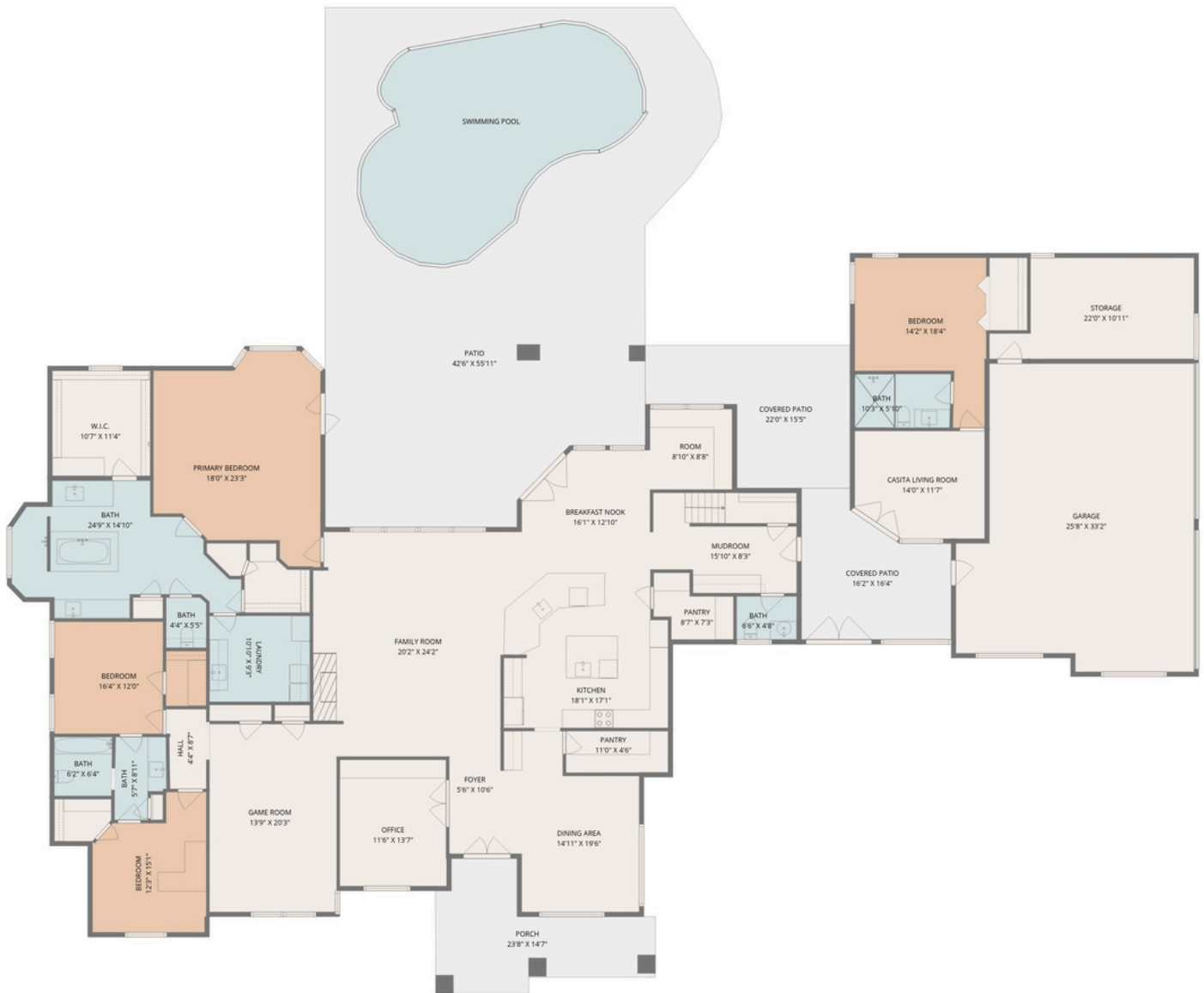

Measurements Are Deemed Highly Reliable But Not Guaranteed