

# Building Sketch (Page - 1)

Borrower	LAWERNCE & JIMMY ROGERS		
Property Address	4510 Cypress Pond Ct		
City	Houston	County	HARRIS
Lender/Client	BBVA HOME EQUITY	State	TX
		Zip Code	77059

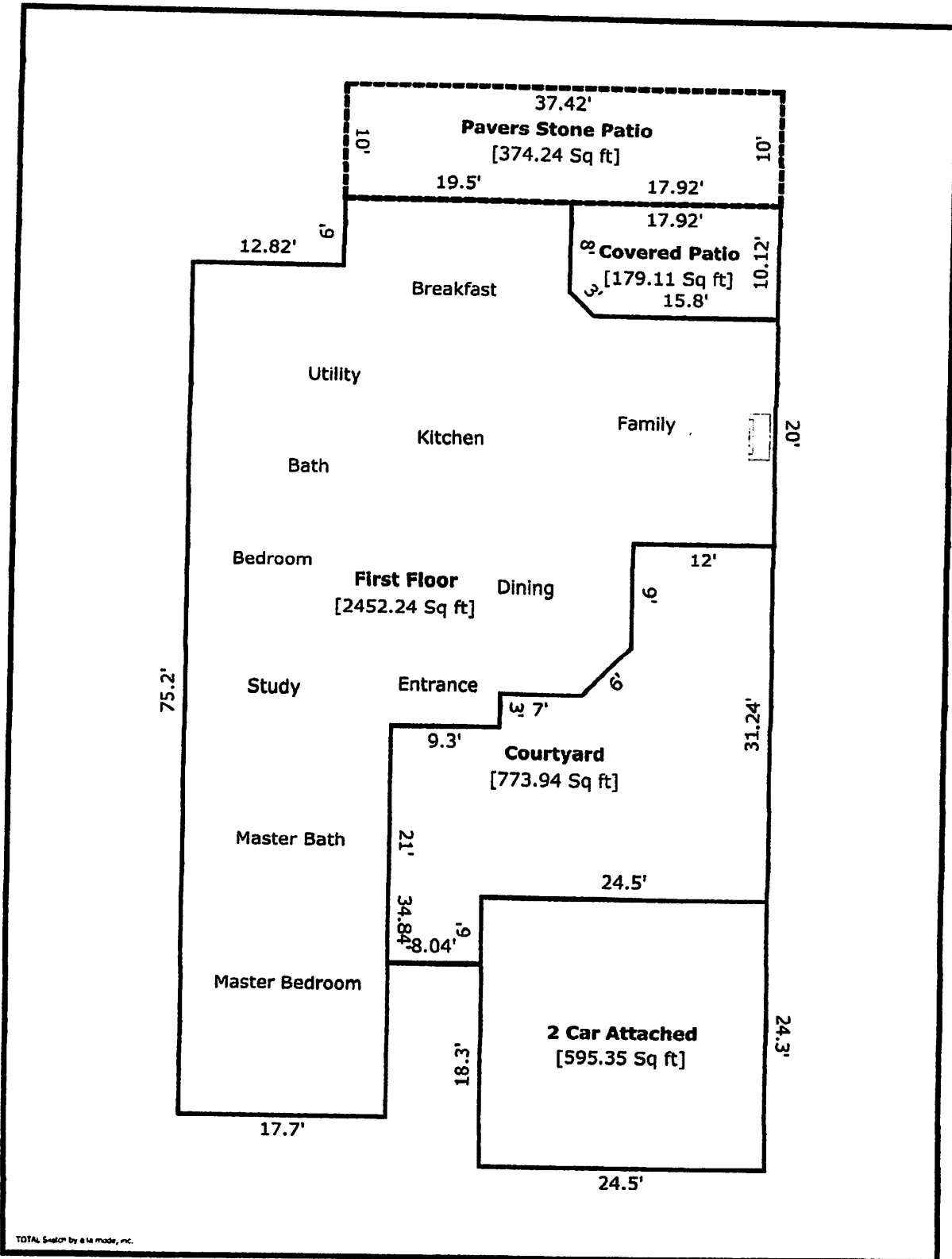

TOTAL Sketch by e la made, inc.

## Building Sketch (Page - 2)

<b>Borrower</b>	LAWERNCE & JIMMY ROGERS		
<b>Property Address</b>	4510 Cypress Pond Ct		
<b>City</b>	Houston	<b>County</b>	HARRIS
<b>Lender/Client</b>	BBVA HOME EQUITY	<b>State</b>	TX
		<b>Zip Code</b>	77059

TOTAL Sketch by aia mode, inc.

### Area Calculations Summary

Living Area	2452.24 Sq ft	Calculation Details
First Floor		$20 \times 12 = 240$ $17.7 \times 34.84 = 616.55$ $40.35 \times 12.82 = 517.47$ $19.5 \times 8 = 156$ $38.35 \times 14.18 = 543.95$ $35.36 \times 5.32 = 188.18$ $1.68 \times 4.24 = 7.12$ $0.5 \times 4.24 \times 4.24 = 9$ $5.92 \times 29 = 171.72$ $0.5 \times 2.12 \times 2.12 = 2.25$
<b>Total Living Area (Rounded):</b>	<b>2452 Sq ft</b>	
<b>Non-living Area</b>		
Pavers Stone Patio	374.24 Sq ft	$10 \times 17.92 = 179.22$ $19.5 \times 10 = 195$ $0.5 \times 19.5 \times 0 = 0.01$
Covered Patio	179.11 Sq ft	$10.12 \times 15.8 = 159.9$ $2.12 \times 8 = 16.97$ $0.5 \times 2.12 \times 2.12 = 2.25$
Courtyard	773.94 Sq ft	$12 \times 9 = 107.98$ $8.04 \times 6 = 48.24$ $15 \times 9.3 = 139.5$ $23.24 \times 18 = 418.32$ $4.24 \times 12 = 50.9$ $0.5 \times 4.24 \times 4.24 = 9$
2 Car Attached	595.35 Sq ft	$24.5 \times 24.3 = 595.35$