

*[Signature]* Ruth Ramirez Valdez

**NOTES:**

- 1.) SUBJECT TO APPLICABLE RESTRICTIVE COVENANTS LISTED IN ITEM No. 1, SCHEDULE "B" OF TITLE COMMITMENT ISSUED BY STAR TEX TITLE COMPANY UNDER GF No. 636814.
- 2.) SURVEYOR HAS NOT ABSTRACTED SUBJECT PROPERTY, ABSTRACTING BY TITLE COMPANY ONLY, THERE MAY BE ADDITIONAL EASEMENTS AND BUILDING LINES.
- 3.) SUBJECT TO BUILDING LINE RESTRICTIONS PER. H.C.C.F.No. X-187916.

- IF CONSTRUCTION UPON OR A DIVISION OF SUBJECT TRACT IS PROPOSED AND IF TRACT LIES IN THE CITY OF HOUSTON OR ITS EXTRATERRITORIAL JURISDICTION, PLATTING AND OTHER REQUIREMENTS MAY APPLY PER CITY OF HOUSTON ORDINANCES.  
 - ALL BEARINGS SHOWN ARE BASED ON THE RECORDED PLAT.



SUBJECT PROPERTY IS NOT LOCATED IN A FEDERAL INSURANCE ADMINISTRATION DESIGNATED FLOOD HAZARD AREA, LOCATED IN ZONE "X", AS PER MAP 48201 C 0805 L, DATED: 06/18/2007.  
 THIS INFORMATION IS BASED ON GRAPHIC PLOTTING ONLY, WE DO NOT ASSUME RESPONSIBILITY FOR EXACT DETERMINATION.

<b>LOT</b>		<b>SUBDIVISION</b>	
15		BRENWOOD	
<b>BLOCK</b>	<b>SECTION</b>	<b>RECORDATION</b>	
4	7	FILM CODE No. 538172, H.C.M.R.	
<b>COUNTY</b>	<b>STATE</b>	I HEREBY CERTIFY THAT THIS PLAT REPRESENTS THE RESULTS OF A SURVEY MADE ON THE GROUND ON THE 13th DAY OF JULY, 2009	
HARRIS	TEXAS		
<b>LENDER Co.</b>	LEGACY TEXAS MORTGAGE		
<b>TITLE Co.</b>	STAR TEX TITLE COMPANY		
<b>PURCHASER</b>	NOE VALDEZ		
<b>ADDRESS</b>	6026 DUNSLEY DRIVE KATY, TEXAS		

I HEREBY CERTIFY THAT THIS PLAT REPRESENTS THE RESULTS OF A SURVEY MADE ON THE GROUND ON THE 13th DAY OF JULY, 2009

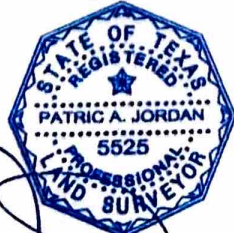

TEL: (713) 722-7541 FAX: (713) 722-7613

<b>JOB No.</b>	09-21131	
<b>G.F. No.</b>	635814	
<b>FIELD WORK</b>	07/13/2009	DT
<b>DRAFTED BY</b>	07/13/2009	RG
<b>CHECKED BY</b>	07/13/2009	PJ
<b>KEY MAP</b>	407 W	
<b>REVISION</b>	-	

**MERIDIAN**  
 SURVEYING & MAPPING  
 1080 W. SAM HOUSTON PKWY., N., STE. 113  
 HOUSTON, TEXAS 77043