



NOTICE OF INFORMATION FROM OTHER SOURCES

USE OF THIS FORM BY PERSONS WHO ARE NOT MEMBERS OF THE TEXAS ASSOCIATION OF REALTORS®, INC. IS NOT AUTHORIZED.
©Texas Association of REALTORS®, Inc. 2008

To: _____

From: Martha Turner Sotheby's International Realty (Broker)

Property Address: 875 Glenchester Dr., Houston, TX 77079

Date: April 1, 2026

(1) Broker obtained the attached information, identified as Building Sketch (3 pages)

from Andrew Mobley Cox, Certified Residential Real Estate Appraiser

(2) Broker has relied on the attached information and does not know and has no reason to know that the information is false or inaccurate except: N/A

(3) **Broker does not warrant or guarantee the accuracy of the attached information. Do not rely on the attached information without verifying its accuracy.**

Martha Turner Sotheby's International Realty

Broker

By: 
532A75FA70E4465...

Receipt of this notice is acknowledged by:

Signature Date

Signature Date

APPRAISAL CERTIFICATION-Andrew Cox



Certified Residential Real Estate Appraiser

Appraiser: ANDREW MOBLEY COX

License #: 1329893-CR

License Expires: 01/31/2027

Having provided satisfactory evidence of the qualifications required by the Texas Appraiser Licensing and Certification Act, Occupations Code, Chapter 1103, authorization is granted to use this title:
Certified Residential Real Estate Appraiser

For additional information or to file a complaint please contact TALCB at www.talcb.texas.gov.

**Chelsea Buchholtz
Executive Director**

Building Sketch (Page - 1)

Borrower/Client	FOR SQUARE FOOTAGE ONLY			
Property Address	875 Glenchester Dr			
City	Houston	County	Harris	State TX Zip Code 77079
Lender				

FOR SQUARE FOOTAGE PURPOSE ONLY

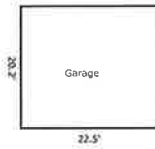

FOR SQUARE FOOTAGE PURPOSE ONLY

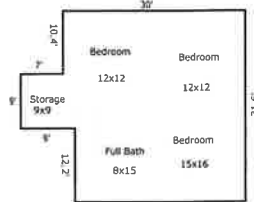
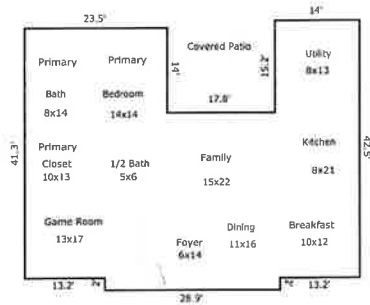

Second Floor

Andrew M. Cox
State Certified Real Estate Appraiser
TX-1329893-R

Building Sketch (Page - 2)

Borrower/Client	FOR SQUARE FOOTAGE ONLY			
Property Address	875 Glenchester Dr			
City	Houston	County	Harris	State TX Zip Code 77079
Lender				

TOTAL Sketch by a la mode

Area Calculations Summary

Living Area		Calculation Details
First Floor	2109.29 Sq ft	$28.9 \times 2 = 57.8$ $14 \times 15.2 = 212.8$ $27.3 \times 31.8 = 868.14$ $23.5 \times 41.3 = 970.55$
Second Floor	986.6 Sq ft	$31.6 \times 28 = 884.8$ $9 \times 9 = 81$ $10.4 \times 2 = 20.8$
Total Living Area (Rounded):	3096 Sq ft	
Non-living Area		
2 Detached Gar	454.5 Sq ft	$20.2 \times 22.5 = 454.5$