

SURVEYOR'S NOTE(S):
BASIS OF BEARING, TEXAS SOUTH CENTRAL NAD 83.

THIS SURVEY MEETS THE CURRENT STANDARDS OF THE TEXAS SOCIETY OF PROFESSIONAL SURVEYORS STANDARDS AND SPECIFICATION FOR A CATEGORY 1A, CONDITION II SURVEY.

THE SETBACKS AND EASEMENTS SHOWN ON THIS DRAWING ARE THE BEST INTERPRETATION OF THE SURVEYORS BASED ON THE INFORMATION AVAILABLE TO US AT THE TIME OF THE DRAWING.

THIS SURVEY IS BASED ON A TITLE COMMITMENT REPORT ISSUED BY OLD REPUBLIC NATIONAL TITLE INSURANCE COMPANY GF NO. 22140730-ALGA ISSUED ON 05/18/22.

FLOOD INFORMATION
FIRM: 48201C PANEL: 0665 M
REV. DATE: 06/09/2014
ZONE: "X"

FLOOD INFORMATION PROVIDED HEREON IS BASED ON SCALING THE LOCATION OF THE SUBJECT TRACT ON THE FLOOD INSURANCE RATE MAPS, THE INFORMATION SHOULD BE USED TO DETERMINE FLOOD INSURANCE RATES ONLY AND IS NOT INTENDED TO IDENTIFY SPECIFIC FLOODING CONDITIONS. WE ARE NOT RESPONSIBLE FOR THE F.I.R.M.'S ACCURACY.

LEGEND

These standard symbols will be found in the drawing.

- BOUNDARY LINE
- EASEMENT LINE
- BUILDING SETBACK LINE
- WOOD FENCE
- WROUGHT IRON FENCE
- SET 1/2" IRON ROD WITH CAP
- FOUND IRON ROD
- FOUND METAL PIPE
- CONTROL MONUMENT



GRAPHIC SCALE



I, DAVID E. KING, JR, a Registered Professional Land Surveyor in the State of Texas, do hereby certify to ALLEGIANCE TITLE LLC DBA ALLEGIANCE TITLE COMPANY and NETWORK FUNDING LP

that the above map is true and correct according to an actual field survey, made by me or under my supervision, of the property shown hereon or described by field notes accompanying this drawing. I further certify that all easements and rights-of-way of which I have been advised are shown hereon and that, except as shown, there are no apparent visible encroachments, no apparent visible overlapping of improvements and no apparent discrepancies or conflicts in the boundary lines, as of the date of the field survey.

Borrower/Owner: RYAN CHAMBERLAIN AND KATIE CHAMBERLAIN
Address: 2011 WILLOWMOSS CT., HOUSTON, TX 77008 GF No. 22140730-ALGA

Legal Description of the Land:

Lot Nine (9), in Block Twelve (12), of LAZYBROOK. SECTION EIGHT (8), a Subdivision in Harris County, Texas, According to the Map or Plat thereof recorded in Volume 145, Page 56, of the Map Records of Harris County, Texas.

SUBJECT TO RESTRICTIVE COVENANTS AND/OR EASEMENTS RECORDED IN: VOLUME 145, PAGE 56, MAP RECORDS, HARRIS COUNTY, TEXAS

PROPERTY PHOTOGRAPH:



LAND TITLE SURVEY

JOB NO.:	2205034484	NO.	REVISION	DATE
DATE:	05/24/22			
DRAWN BY:	DBT			
APPROVED BY:	DEK			

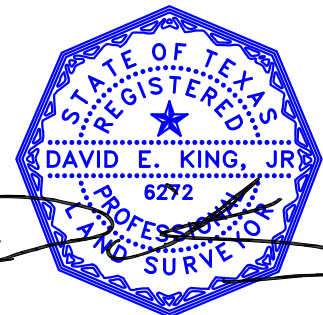

FIRM REGISTRATION NO. 10190700

DAVID E. KING, R.P.L.S.
Registered Professional Land Surveyor
Registration No. 6272

COPYRIGHT ALL RIGHTS RESERVED TO OVERLAND CONSORTIUM INC.

Overland Consortium Inc. Surveyors

Tel: 281-940-8869 Fax: 281-207-6476

999 E. BASSE ROAD, SUITE 180 BOX 521, SAN ANTONIO, TEXAS 78212