

LOT 23

LOT 21

LOT 22
BLOCK 2
TWO STORY
BRICK FRAME

CLEARWOOD DRIVE
(60' R.O.W.)

WOOD CREEK LANE
(60' R.O.W.)

Sandra Jean Venturini

Marcello A. Venturini by Sandra Jean Venturini Attorney in Fact

- NOTES:
1. ALL BEARINGS SHOWN HEREON ARE BASED ON THE RECORDED PLAT.
 2. SUBJECT TO APPLICABLE RESTRICTIVE COVENANTS LISTED IN ITEM No.1, SCHEDULE "B" OF TITLE COMMITMENT ISSUED BY NORTH AMERICAN TITLE INSURANCE COMPANY UNDER G.F. No. 14623-12-00515.
 3. AGREEMENT FOR UNDERGROUND ELECTRICAL SERVICE PER C.F. No. 20100365837.

PLAT OF SURVEY
SCALE: 1" = 20'

FLOOD MAP:
THIS PROPERTY LIES IN ZONE "X"
AS DEPICTED ON COMMUNITY PANEL
No. 4854880025 D, EFFECTIVE DATE: 09-22-99.

"THIS INFORMATION IS BASED ON GRAPHIC PLOTTING.
WE DO NOT ASSUME RESPONSIBILITY FOR EXACT
DETERMINATION"

© 2013, ALLPOINTS SERVICES, CORP., All Rights Reserved. This original work is protected under copyrights laws, Title 17 U.S. Code Sections 101 & 102. All violators will be prosecuted to the extent of the law. This survey is being provided solely for the use of the recipients and no license has been created, express or implied, to copy the survey except as is necessary in conjunction with the original transaction.

FOR: SANDRA JEAN VENTURINI
AND MARCELLO A. VENTURINI
ADDRESS:
6304 WOOD CREEK LANE
ALLPOINTS JOB #: LH50225 JB
G.F.: 14623-12-00515

LOT 22, BLOCK 2,
WESTWOOD SUBDIVISION, PHASE 1,
PLAT RECORD 2006A, MAP NO. 220-222,
GALVESTON COUNTY, MAP RECORDS

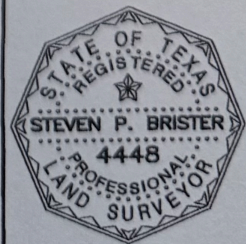

I HEREBY CERTIFY THAT THIS PLAT REPRESENTS THE
RESULTS OF A SURVEY MADE ON THE GROUND, ON THE 19th
DAY OF MARCH, 2013.

Steven P. Brister