

SURVEYOR'S NOTE(S):
 THIS SURVEY MEETS THE CURRENT STANDARDS OF THE TEXAS SOCIETY OF PROFESSIONAL SURVEYORS STANDARDS AND SPECIFICATION FOR A CATEGORY 1A, CONDITION II SURVEY.

THIS SURVEY IS BASED ON A TITLE COMMITMENT REPORT ISSUED BY CHARTER TITLE COMPANY GF NO. CH-4750-1047502200078 ISSUED ON 05/12/22.

BASIS OF BEARING, TEXAS SOUTH CENTRAL NAD 83.

FLOOD INFORMATION
 FIRM: 48201C PANEL: 0670 M
 REV. DATE: 06/09/2014
 ZONE: "X"

FLOOD INFORMATION PROVIDED HEREON IS BASED ON SCALING THE LOCATION OF THE SUBJECT TRACT ON THE FLOOD INSURANCE RATE MAPS, THE INFORMATION SHOULD BE USED TO DETERMINE FLOOD INSURANCE RATES ONLY AND IS NOT INTENDED TO IDENTIFY SPECIFIC FLOODING CONDITIONS. WE ARE NOT RESPONSIBLE FOR THE F.I.R.M.'S ACCURACY.

LEGEND

These standard symbols will be found in the drawing.

- BOUNDARY LINE
- WOOD FENCE
- WROUGHT IRON FENCE
- SET 1/2" IRON ROD WITH CAP
- FOUND IRON ROD
- FOUND METAL PIPE
- CONTROL MONUMENT

GRAPHIC SCALE



I, **DONALD MATT COOKSTON**, a Registered Professional Land Surveyor in the State of Texas, do hereby certify to **CHARTER TITLE COMPANY** and **FIRST HORIZON BANK**

that the above map is true and correct according to an actual field survey, made by me or under my supervision, of the property shown hereon or described by field notes accompanying this drawing. I further certify that all easements and rights-of-way of which I have been advised are shown hereon and that, except as shown, there are no apparent visible encroachments, no apparent visible overlapping of improvements and no apparent discrepancies or conflicts in the boundary lines, as of the date of the field survey.

Borrower/Owner: **SCOTT OLDEBEKEN AND WHITNEY CONKLING**
 Address: **1633 ARLINGTON ST., HOUSTON, TX 77008** GF No. **CH-4750-1047502200078**

Legal Description of the Land: Lot Six (6), in Block One Hundred-fifteen (115), of Houston Heights, a subdivision in Harris County, Texas, according to the map or plat thereof, recorded in Volume 1A, Page 114, of the Map Records of Harris County, Texas

SUBJECT TO RESTRICTIVE COVENANTS AND/OR EASEMENTS RECORDED IN: VOLUME 1A, PAGE 114, MAP RECORDS, HARRIS COUNTY, TEXAS CLERK'S FILE NOS. M409899, M516607, V620908, V719174, W994254, 20130372002, 20130600380, 20140203179, HARRIS COUNTY, TEXAS

PROPERTY PHOTOGRAPH:



LAND TITLE SURVEY

JOB NO.:	2205034282	NO.	REVISION	DATE
DATE:	05/16/22			
DRAWN BY:	MU			
APPROVED BY:	DMC			

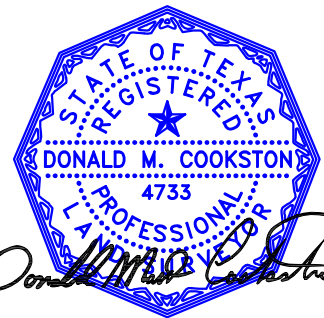

Donald Matt Cookston

FIRM REGISTRATION NO. 10190700

DONALD MATT COOKSTON, R.P.L.S.
 Registered Professional Land Surveyor
 Registration No. 4733

COPYRIGHT ALL RIGHTS RESERVED TO OVERLAND CONSORTIUM INC.

Overland Consortium Inc. Surveyors

Tel: 281-940-8869 Fax: 281-207-6476

999 E. BASSE ROAD, SUITE 180 BOX 521, SAN ANTONIO, TEXAS 78212