

SCALE: 1"=20'-0"

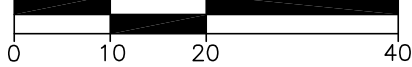

SITE PHOTOGRAPH



CATALPA DRIVE
(50' R.O.W.)

LEGEND:

- CIR - CAPPED IRON ROD
- "STS" - STAMPED SOUTH TEXAS SURVEYING
- COVERED CONCRETE
- WOOD FENCE
- SANITARY MANHOLE
- STORM MANHOLE
- WATER METER

NOTES:

1. BOUNDARY BASED ON GPS OBSERVATION TEXAS SOUTH CENTRAL ZONE.
2. SURVEYOR DID NOT ABSTRACT PROPERTY. SURVEY BASED ON LEGAL DESCRIPTIONS RECORDED IN 2011086458 DEED RECORDS OF FORT BEND COUNTY, TEXAS.
3. NOTHING IN THIS SURVEY IS INTENDED TO EXPRESS AN OPINION REGARDING OWNERSHIP OR TITLE.
4. THE WORD CERTIFY IS UNDERSTOOD TO BE AN EXPRESSION OF PROFESSIONAL JUDGMENT BY THE SURVEYOR, WHICH IS BASED ON HIS BEST KNOWLEDGE, INFORMATION AND BELIEF.
5. SURVEY IS CERTIFIED FOR THIS TRANSACTION ONLY.
6. THE FINDINGS AND OPINIONS OF SOUTH TEXAS SURVEYING ASSOCIATES, INC. REFLECTED HEREON ARE PRIVILEGED, CONFIDENTIAL AND INTENDED FOR THE USE OF THE INDIVIDUAL OR ENTITY FOR WHOM THIS WORK WAS PREPARED, IT IS UNDERSTOOD THAT THE USE OF, RELIANCE ON, OR REPRODUCTION OF SAME, IN WHOLE OR IN PART, BY OTHERS WITHOUT THE EXPRESS WRITTEN CONSENT OF SOUTH TEXAS SURVEYING ASSOCIATES, INC. IS PROHIBITED AND WITHOUT WARRANTY, EXPRESS OR IMPLIED. SOUTH TEXAS SURVEYING ASSOCIATES, INC. SHALL BE HELD HARMLESS AGAINST DAMAGES OR EXPENSES RESULTING FROM SUCH UNAUTHORIZED USE, RELIANCE OR REPRODUCTION. COPYRIGHT 2025. ALL RIGHTS RESERVED.
7. THIS SURVEY WAS PERFORMED WITHOUT THE BENEFIT OF A TITLE REPORT. CERTAIN EASEMENTS AND/OR BUILDING LINES MAY HAVE BEEN GRANTED WHICH ARE NOT REFLECTED HEREON. THIS SURVEY IS SUBJECT TO ANY FACTS THAT MAY BE DISCLOSED BY A FULL AND ACCURATE TITLE SEARCH. THIS SURVEY WAS DONE WITHOUT BENEFIT OF DEED. OWNER SHOULD OBTAIN A TITLE COMMITMENT BEFORE DESIGN OR CONSTRUCTION COMMENCES.

LOT 21, BLOCK 6, DEL WEBB-RICHMOND, SECTION TWO, A SUBDIVISION IN FORT BEND COUNTY, TEXAS, ACCORDING TO THE MAP OR PLAT THEREOF RECORDED IN PLAT NO. 2010022 OF THE PLAT RECORDS OF FORT BEND COUNTY, TEXAS.

PROPERTY LIES WITHIN FLOOD ZONE "X", ACCORDING TO F.I.R.M. MAP NO. 48157C 0245L, DATE 04-02-2014. BY GRAPHING PLOTTING ONLY, WE DO NOT ASSUME RESPONSIBILITY FOR EXACT DETERMINATION.

BEFORE ANY DEVELOPMENT PLANNING, DESIGN, OR CONSTRUCTION IS STARTED, THE COMMUNITY, CITY AND COUNTY IN WHICH SUBJECT TRACT EXISTS SHOULD BE CONTACTED. SAID ENTITIES MAY IMPOSE LARGER FLOOD PLAIN AND FLOODWAY AREAS THAN SHOWN BY F.I.R.M. MAPS THAT WILL AFFECT DEVELOPMENT.

PROPERTY SUBJECT TO CITY ORDINANCES AND SUBDIVISION COVENANTS, CONDITIONS AND RESTRICTIONS.

I hereby certify that this survey was made on the ground and that this plat correctly represents the facts found at the time of survey showing any improvements, from legal descriptions supplied by client. There are no encroachments apparent on the ground, except as shown. This survey is only certified for boundary and this transaction only. Surveyor did not abstract property. Easements, building lines, etc. shown are as identified by:

GF N/A of N/A

Fred F. Lawton, Registered Professional Land Surveyor No. 5530

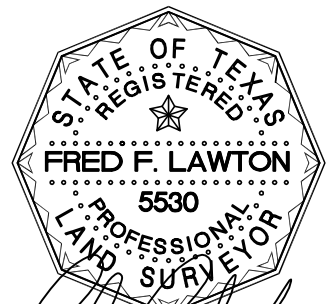

ADDRESS: 1119 CATALPA DRIVE

CITY: RICHMOND, TEXAS

PURCHASER:

LENDER:

ZIP: 77469

JOB NO: 2179-25 DATE: 10-03-25 SCALE: 1"=20'-00" REVISION:



SOUTH TEXAS SURVEYING ASSOCIATES, INC.

11281 Richmond Ave. Bldg J-Suite 101 Houston, Texas 77082

TEL. 281-556-6918 FAX 281-556-9331

Firm Number: 10045400

Copyright 2025 South Texas Surveying Associates, Inc.

K:\COMRES 2025\2179-25.DWG (BC)

JOB NO: 2179-25