

**BLACKTAIL PLACE
(CUL-DE-SAC)**

NOTES:

1. ALL BEARINGS SHOWN HEREON ARE BASED ON THE RECORDED PLAT.
2. SUBJECT TO APPLICABLE RESTRICTIVE COVENANTS LISTED IN ITEM No.1, SCHEDULE "B" OF TITLE COMMITMENT ISSUED BY OLD REPUBLIC NATIONAL TITLE INSURANCE COMPANY UNDER G.F. No. 9812002673.
3. ALL ELEVATIONS SHOWN HEREON ARE BASED ON ASSUMED DATUM.

**PLAT OF SURVEY
SCALE: 1" = 30'**

FLOOD MAP:
THIS PROPERTY LIES IN ZONE "X" AS DEPICTED ON COMMUNITY PANEL No. 49339 C 0365 F, DATED: 12-19-96.
THIS INFORMATION IS BASED ON GRAPHIC PLOTTING ONLY. WE DO NOT ASSUME RESPONSIBILITY FOR EXACT DETERMINATION

© 2011, ALLPOINTS SERVICES, CORP. All Rights Reserved. This original work is protected under copyright laws, Title 17 U.S. Code Sections 101 & 102. All violators will be prosecuted to the extent of the law. This survey is being provided solely for the use of the recipients and no license has been created, expressed or implied, to copy the survey except as is necessary in conjunction with the original transaction.

FOR: THOMAS A VARADY
MARY J VARADY
ADDRESS: 131 BLACKTAIL PLACE
ALLPOINTS JOB No.: HD37586CG
G.F.: (6812002673)

**LOT 31, BLOCK 1,
WOODFOREST, SEC. 6,
CAB. "Z", SHT. 1864-1867, MAP RECORDS,
MONTGOMERY COUNTY, TEXAS**

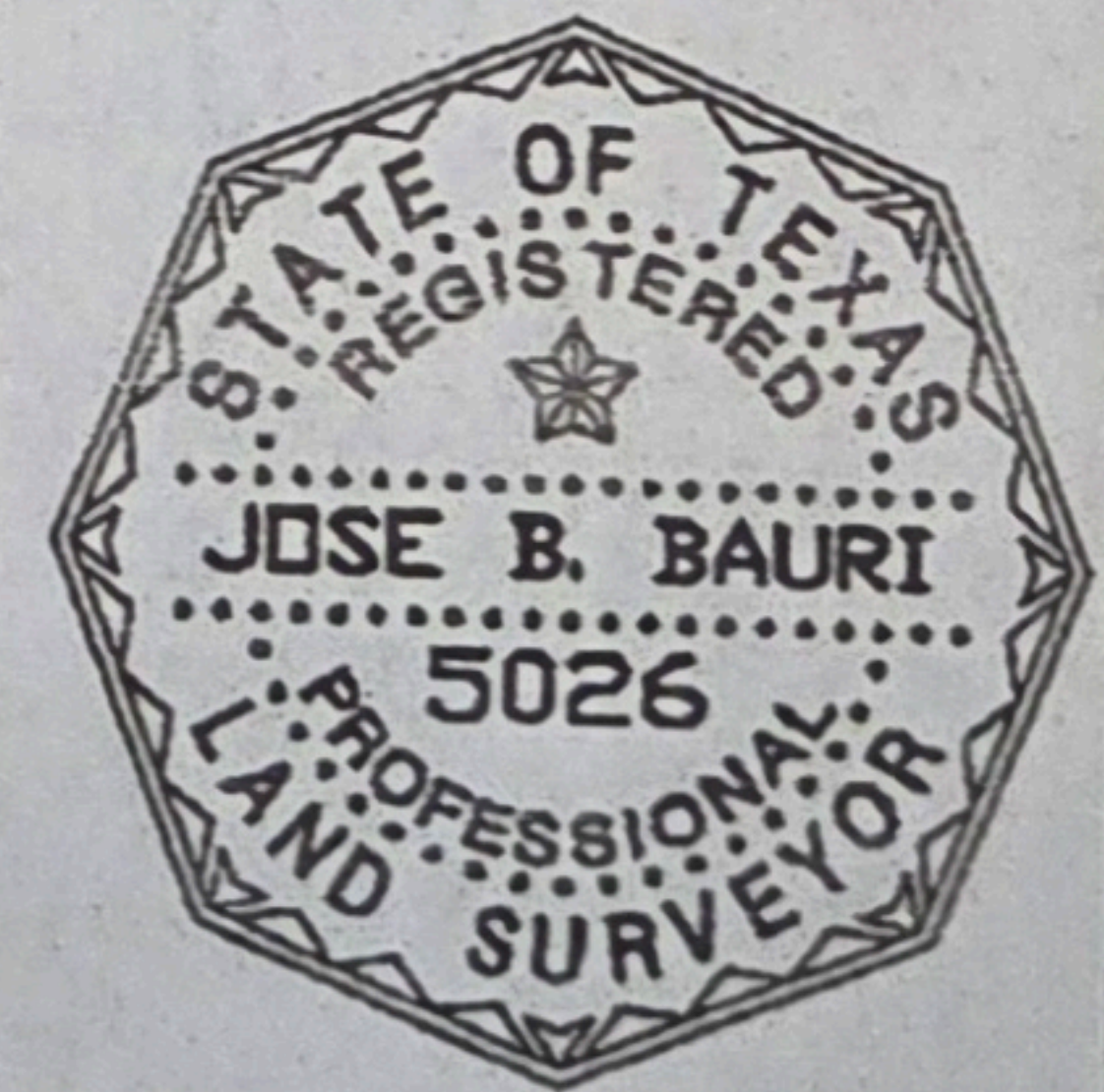

I HEREBY CERTIFY THAT THIS PLAT REPRESENTS THE RESULTS OF A SURVEY MADE ON THE GROUND, ON THE 8th DAY OF DECEMBER, 2011.

Jose B. Bauri

ALLPOINTS SERVICES CORP. COMMERCIAL/BUILDER DIVISION 1515 WITTE ROAD, HOUSTON, TEXAS 77080