

D-93A1

LEASE PARCEL NO. **D-931A** SURVEYED BY HIGH TIDE SURVEYING LLC ON 7/28/2022.
 JOB NO. 22-0333.

SURVEY OF WATER FRONT LEASE PARCEL D-93A2 AS SHOWN ON THE LEASE PLATS OF CLEAR LAKE SHORES BY J. G. STRICKLAND (R.P.S., NO. 864), FILES IN THE OFFICE OF THE CITY SECRETARY OF THE CITY OF CLEAR LAKE SHOES, GALVESTON COUNTY, TEXAS.

SCALE: 1"=20'
 DATE: 8/31/22
 REVISED:
 SURVEY BY: B.L.S.
 DRAWN BY: B.L.S.
 FOR: TED GUTHERY

THIS PLAT IS AN ACCURATE REPRESENTATION OF THAT SURVEY MADE ON THE GROUND UNDER MY SUPERVISION. THERE ARE NO APPARENT ENCROACHMENTS OR CONFLICTS ACROSS PROPERTY LINES AT THE TIME OF THIS SURVEY, EXCEPT AS SHOWN HEREON.

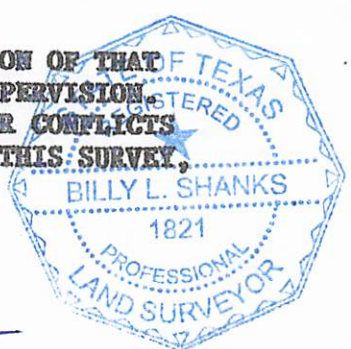

PURCHASER:
 JOB NO: 8/31/22
 FIRM 10193000
 billyshanks81@gmail.com

BILLY L. SHANKS
 4902 CAROLINE ST., SEABROOK, TX. 77586

281-808-4789
 FAX 281-942-9009

WATER FRONT LEASE PLOT NO. D-93A2, CITY OF CLEAR LAKE SHORES ACCORDING TO PLAT PREPARED BY J. G. STRICKLAND (R.P.S. NO. 864) ON JULY 6th, 1963, SAID PLAT LOCATED IN THE OFFICE OF THE CITY SECRETARY OF CLEAR LAKE SHORE, GALVESTON COUNTY, TEXAS:

COMMENCING AT A 5/8" IRON ROD FOUND AT THE COMMON FRONT CORNER OF LEASE PLOTS 92 AND 93 AS SHOWN ON SECTION "D", PAGE ONE OF SAID PLAT;

THENCE IN A NORTHERLY DIRECTION, ALONG THE EASTERLY LINE OF SAID PLOT 93 AND THE WESTERLY LINE OF WEST SHORE DRIVE (60' R-O-W) BEING A CURVE TO THE RIGHT WITH A RADIUS OF 730.00 FEET, A CENTRAL ANGLE OF 03° 09' 16", A DISTANCE OF 40.19 FEET (CHORD BEARS N 19° 10' 13" E 40.19 FEET) TO A 1/2" IRON ROD FOUND AT THE SOUTHEAST CORNER AND POINT OF BEGINNING OF THIS TRACT;

THENCE N 69° 15' 09" W 26.91 FEET TO A MAG NAIL FOUND IN BULKHEAD AT THE SOUTHWEST CORNER OF THIS TRACT;

THENCE N 26° 10' 05" E, ALONG SAID BULKHEAD A DISTANCE OF 39.99 FEET TO A MAG NAIL FOUND IN BULKHEAD AT THE NORTHWEST CORNER OF THIS TRACT AND THE SOUTHWEST CORNER OF PLOT NO. D-93C:

THENCE S 66° 02' 46" E, ALONG COMMON LINE WITH PLOT D-93C, A DISTANCE OF 24.43 FEET TO AN IRON ROD FOUND AT THE NORTHEAST CORNER OF THIS TRACT LOCATED ON THE WESTERLY LINE OF WEST SHORE DRIVE;

THENCE SOUTHERLY ALONG THE WESTERLY LINE OF WEST SHORE DRIVE, BEING A CURVE TO TO THE LEFT WITH A RADIUS OF 730.00 FEET, A CENTRAL ANGLE OF 03° 01' 18", A DISTANCE OF 38.50 FEET (CHORD BEARS S 22° 37' 26" W 38.50 FEET) TO THE POINT OF BEGINNING AND CONTAINING 1,002 SQUARE FEET OF LAND.



Billy L. Shanks
 BILLY L. SHANKS R.P.L.S. NO. 1821
 8/31/22