

CALL 235.04 ACRES  
 CARLTON WOODS HOLDINGS, LLC.  
 AS DESCRIBED UNDER  
 C.F. NO. 2013071990 H.C.O.P.R.R.

CALL 235.04 ACRES  
 CARLTON WOODS HOLDINGS, LLC.  
 AS DESCRIBED UNDER  
 C.F. NO. 2013071990 H.C.O.P.R.R.

**SUBJECT TO :**

- © 2024 Everything In Christ Services, Inc., All Rights Reserved.
- Survey is valid only if print has original Seal and signature of surveyor on it. Declaration is made to original purchaser of this survey. It is not transferable to additional institutions or subsequent owners.
- This Survey has been done without benefit of a current title report. Surveyor did not abstract title and does not certify to easements or restrictions not shown. Check with your local governing agencies for any additional easements, building lines or other restrictions not reflected on recorded plat.
- See corresponding field note.

I, Craig A. Lancy, a Registered Professional Land Surveyor in the State of Texas, RPLS No. 4507, do hereby certify to (See Note 3) and Purchaser(s) that based upon information provided by said Title Company under G.F. No. (See Note 3) that this survey was this day made under my supervision on the ground of the above described property and the above plat or drawing reflects the findings on the ground of this property at this time. I have shown or noted all easements reflected in said Title Company's report. This Survey conforms to the minimum standards of practice as approved by the Texas Board of Professional Engineers and Land Surveyors. Effective September, 2023.

The basis of bearing is N 06°02'13" W along the lower West line of Lot 3 per record plat

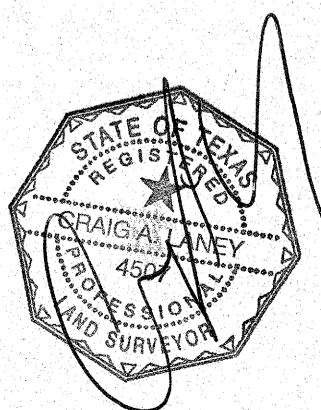

Seal

This Property Lies in Zone " X ", "Shaded X" and "AE"; Outside & Inside the 100 Year Flood Plain Per Graphic Scaling according to Community Panel No.4802870070L having an effective date 06-18-2007 LOMR19-06-2368P; eff.4/18/2022  
 Job No. 24-432-10  
 Scale 1" = 30'  
 Date 11-04-2024  
 Drawn By: MP

**\* THE WOODLANDS CARLTON WOODS CREEKSIDE IN THE VILLAGE OF CREEKSIDE PARK**

Purchaser CLINT CAPSTIN  
 Address 262 SOUTH FAZIO WAY  
 Lot 3, Block 1, Section 16  
 Survey WILLIAM WHITE, A 829  
 Area TRACT 1, 4,122.76 SQ. FT.; TRACT 2, 4,122.76 SQ. FT.  
 Subdivision \*  
 Film Code No. 667228, MAP Records,  
HARRIS County, Texas