

1507 POLK STREET

**SURVEY PLAT SHOWING
 LOT 9 IN BLOCK 239 OF THE
 DAY SUBDIVISION NO. 2 IN
 PORT O'CONNOR TOWNSITE
 VOLUME Z, PAGE 419 OF THE
 CALHOUN COUNTY PLAT RECORDS
 SANTIAGO GONZALES SURVEY
 ABSTRACT NO. 19
 CALHOUN COUNTY, TEXAS**

FLOOD DATA
 ACCORDING TO THE APPROXIMATE SCALE OF THE
 NATIONAL FLOOD INSURANCE RATE MAP, COMMUNITY
 PANEL NO. 48057C 0208 D, REVISED OCTOBER 16, 2014
 THIS PROPERTY IS LOCATED IN ZONE AE.

LEGEND
 ○ EXISTING 5/8" IRON ROD
 —E— OVERHEAD POWERLINE
 [] PLAT OR DEED CALL

I, HENRY A. DANYSH, A REGISTERED PROFESSIONAL LAND SURVEYOR, DO HEREBY CERTIFY THAT THE PLAT SHOWN HEREON REPRESENTS THE RESULT OF A SURVEY MADE ON THE GROUND UNDER MY DIRECTION ON NOVEMBER 1, 2021.

Henry A. Danysh
 G & W ENGINEERS, INC.
 HENRY A. DANYSH
 REGISTERED PROFESSIONAL
 LAND SURVEYOR NO. 5088

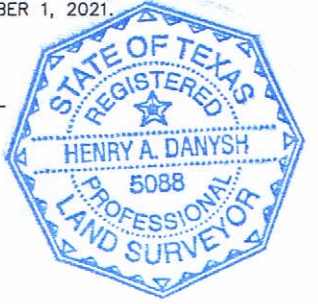

COLENE CLARK

G & W ENGINEERS, INC.
 • ENGINEERING • SURVEYING • PLANNING •

205 W. LIVE OAK STREET
 PORT LAVACA, TEXAS 77979
 TBPELS FIRM NO.: 10022100
 (361) 552-4509: PORT LAVACA
 (979) 323-7100: BAY CITY