



NOTICE OF INFORMATION FROM OTHER SOURCES

USE OF THIS FORM BY PERSONS WHO ARE NOT MEMBERS OF THE TEXAS ASSOCIATION OF REALTORS®, INC. IS NOT AUTHORIZED. ©Texas Association of REALTORS®, Inc. 2008

To: Prospective Buyer

From: Compass RE Texas LLC (Broker)

Property Address: 38 Terraglen Dr, The Woodlands, TX 77382

Date: 03/17/2026

(1) Broker obtained the attached information, identified as Appraisal Sketch from Montgomery Appraisals, LLC / Rick Taylor

(2) Broker has relied on the attached information and does not know and has no reason to know that the information is false or inaccurate except: N/A

(3) Broker does not warrant or guarantee the accuracy of the attached information. Do not rely on the attached information without verifying its accuracy.

Compass RE Texas LLC
Broker

By: Kathleen Merchant Kathleen Merchant

Receipt of this notice is acknowledged by:

Signature Date

Signature Date

Building Sketch

Borrower	Harper						
Property Address	38 Terraglen Drive						
City	The Woodlands	County	Montgomery	State	TX	Zip Code	77382
Lender/Client	N/A						

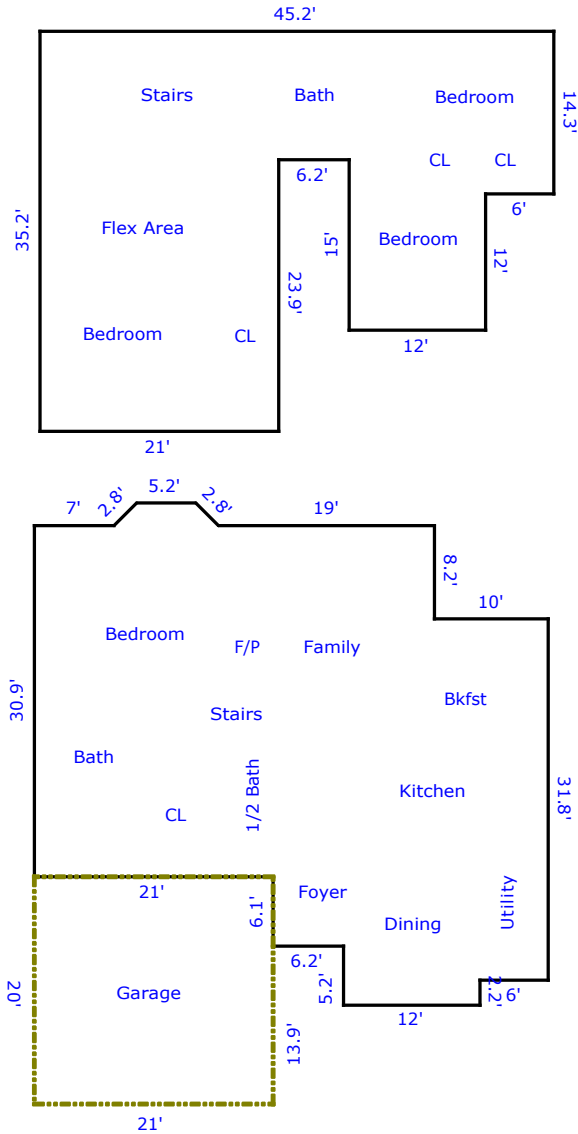

TOTAL Sketch by a la mode

Area Calculations Summary

Living Area	Calculation Details	
First Floor	1557.1 Sq ft	$0.5 \times 2 \times 2 = 2$ $0.5 \times 2 \times 2 = 2$ $5.2 \times 2 = 10.4$ $30.9 \times 21 = 648.9$ $14.2 \times 8.2 = 116.4$ $24.2 \times 28.8 = 697$ $3 \times 6 = 18$ $5.2 \times 12 = 62.4$
Second Floor	1210.7 Sq ft	$21 \times 23.9 = 501.9$ $12 \times 12 = 144$ $14.3 \times 18 = 257.4$ $27.2 \times 11.3 = 307.4$
Total Living Area (Rounded):	2768 Sq ft	
Non-living Area		
2 Car Attached	420 Sq ft	$21 \times 20 = 420$