

[BAY POINT DRIVE]



CONCRETE

BAY

RIDGE

CURB

DRIVE

CURB

[30']

[N58°52'46"]
[50.00']
S58°54'05"W
50.00'

[N58°52'46"]
[50.00']

N58°54'05"E
50.00'

N=13,445,257.05
E= 2,850,901.34

[10' UTILITY ESMT.]

EJB []

[25' BUILDING LINE]



BEARINGS AND COORDINATES SHOWN
HEREON ARE TEXAS STATE PLANE
SOUTH CENTRAL ZONE NAD'83 GRID.

LOT
64

LOT
63

LOT
62

LOT
61

LOT
60

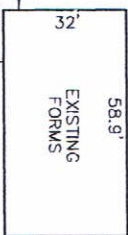

[40' BUILDING LINE]

LOT
65X

LOT
64X

LOT
63X

LOT
62X

LOT
61X

LOT
60X

[N31°07'14"W]
[380.94']

N31°05'55"W
90.28'

21.22'

S61°03'58"W
50.51'

EXISTING EDGE
OF WATER

3125 BAY RIDGE DRIVE

TRES PALACIOS BAY

SURVEY PLAT SHOWING
LOT 62 OF THE
BEACHSIDE SUBDIVISION
SLIDE NO. 445A - 452A OF THE
MATAGORDA COUNTY PLAT RECORDS
AND LOT 62X OF THE
REPLAT BEACHSIDE, RESUBDIVISION NO. 1
SLIDE NO. 540B - 544A OF THE
MATAGORDA COUNTY PLAT RECORDS
D. C. COLLINGSWORTH SURVEY
ABSTRACT NO. 129
MATAGORDA COUNTY, TEXAS

CHAD BRANDT

LEGEND

- EXISTING 5/8" IRON ROD
- EJB ELECTRICAL JUNCTION BOX
- [] PLAT OR DEED CALL

FLOOD DATA

ACCORDING TO THE APPROXIMATE SCALE OF THE
NATIONAL FLOOD INSURANCE RATE MAP, COMMUNITY
PANEL NO. 485489 0503 C, REVISED MARCH 18, 1985.
THIS PROPERTY IS LOCATED IN ZONE V18.

I, HENRY A. DANYSH, A REGISTERED PROFESSIONAL LAND
SURVEYOR, DO HEREBY CERTIFY THAT THE PLAT SHOWN HEREON
REPRESENTS THE RESULT OF A SURVEY MADE ON THE GROUND
UNDER MY DIRECTION ON MARCH 14, 2019.

G & W ENGINEERS, INC.
HENRY A. DANYSH
REGISTERED PROFESSIONAL
LAND SURVEYOR NO. 5088

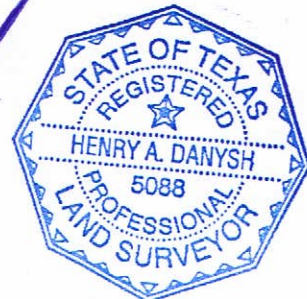

G & W ENGINEERS, INC.

• ENGINEERING • SURVEYING • PLANNING •

205 W. LIVE OAK STREET
PORT LAVACA, TEXAS 77979
TBPLS FIRM NO.: 10022100
(361) 552-4509: PORT LAVACA
(979) 323-7100: BAY CITY

