

## Building Sketch

|                  |                     |        |       |                   |
|------------------|---------------------|--------|-------|-------------------|
| Client           | Measure             |        |       |                   |
| Property Address | 130 Lattice Gate St |        |       |                   |
| City             | Spring              | County | State | TX Zip Code 77382 |
| Owner            | Joseph D Huffaker   |        |       |                   |

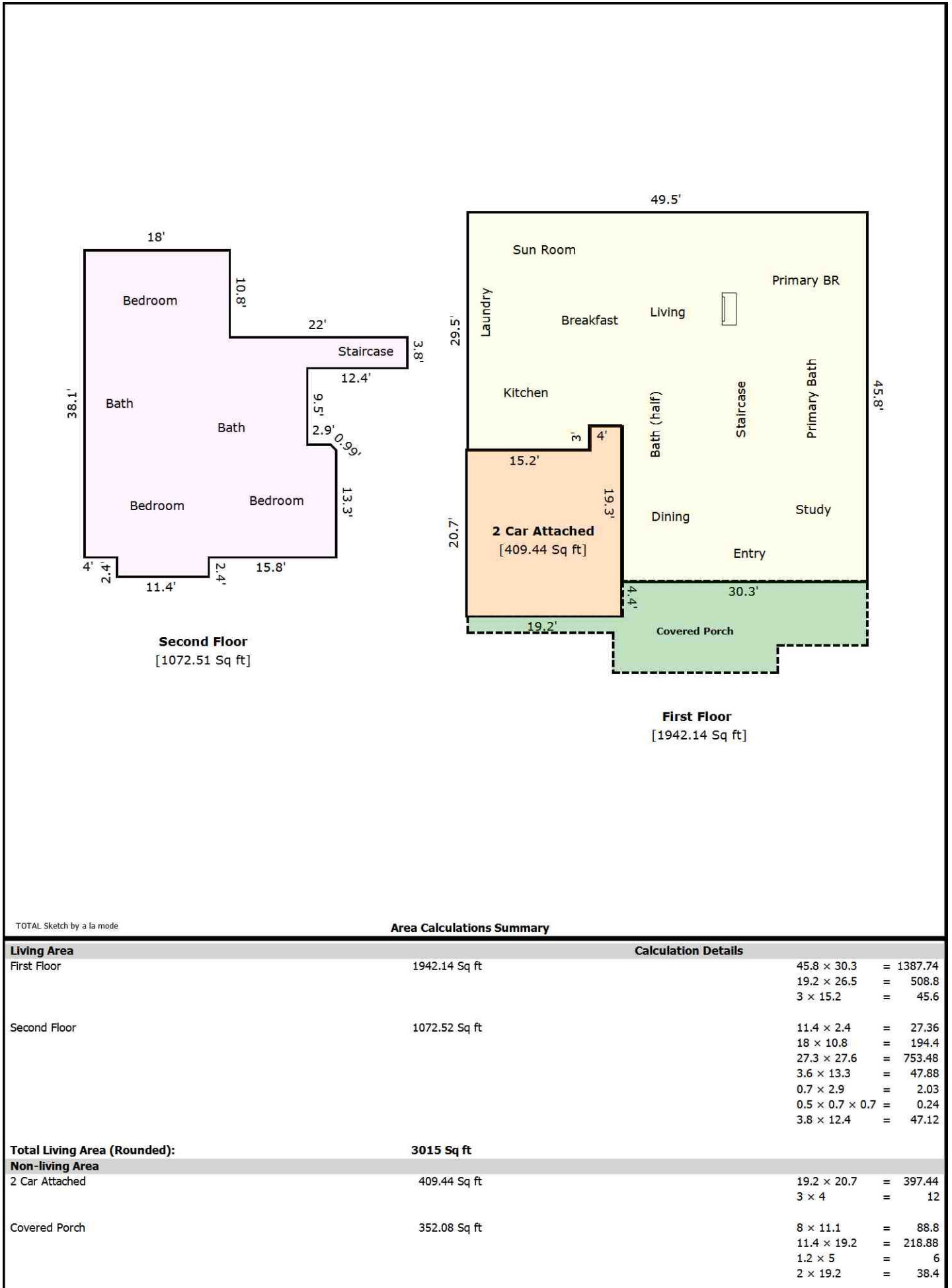

### Area Calculations Summary

| Living Area                         | Area              | Calculation Details   |
|-------------------------------------|-------------------|---|
| First Floor                         | 1942.14 Sq ft     | $45.8 \times 30.3 = 1387.74$<br>$19.2 \times 26.5 = 508.8$<br>$3 \times 15.2 = 45.6$  |
| Second Floor                        | 1072.52 Sq ft     | $11.4 \times 2.4 = 27.36$<br>$18 \times 10.8 = 194.4$<br>$27.3 \times 27.6 = 753.48$<br>$3.6 \times 13.3 = 47.88$<br>$0.7 \times 2.9 = 2.03$<br>$0.5 \times 0.7 \times 0.7 = 0.24$<br>$3.8 \times 12.4 = 47.12$ |
| <b>Total Living Area (Rounded):</b> | <b>3015 Sq ft</b> |   |
| <b>Non-living Area</b>              |                   |   |
| 2 Car Attached                      | 409.44 Sq ft      | $19.2 \times 20.7 = 397.44$<br>$3 \times 4 = 12$  |
| Covered Porch                       | 352.08 Sq ft      | $8 \times 11.1 = 88.8$<br>$11.4 \times 19.2 = 218.88$<br>$1.2 \times 5 = 6$<br>$2 \times 19.2 = 38.4$   |