

LOT SIZE AND COVERAGE TABLE

LOT NO.	LOT SIZE (SQ. FEET)	% COVERAGE NOT TO EXCEED	MAX BUILDING PAD COVERAGE NOT TO EXCEED (SQ FOOT)
1	1,980	60% MAX	1,188
2	1,607	60% MAX	964
3	1,612	60% MAX	967
4	2,400	60% MAX	1,440
5	2,400	60% MAX	1,440

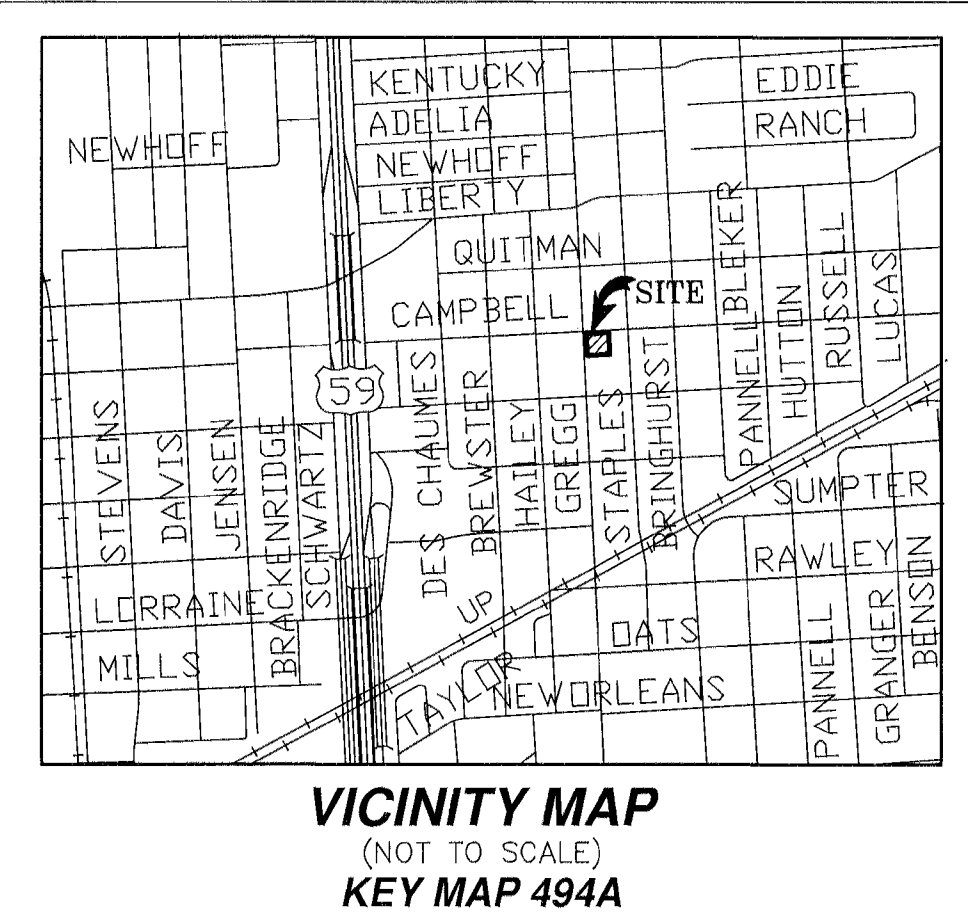

- LEGEND:**
- "B.L." INDICATES BUILDING LINE
 - "U.E." INDICATES UTILITY EASEMENT
 - "H.C.M.R." INDICATED HARRIS COUNTY MAP RECORDS
 - "H.C.C.F." INDICATES HARRIS COUNTY CLERKS FILE
 - "H.C.D.R." INDICATES HARRIS COUNTY DEED RECORDS
 - "R.O.W." INDICATES RIGHT OF WAY
 - "ESMT." INDICATES EASEMENT
 - "H.L. & P." INDICATES HOUSTON LIGHTING & POWER COMPANY
 - "O" INDICATES IRON ROD SET
 - "* " INDICATES IRON ROD FOUND
 - "G.B.L." INDICATES GARAGE BUILDING LINE

STATE OF TEXAS
COUNTY OF HARRIS

I, ANGBEEN SAEED, OWNER (OR OWNERS) HERINAFTER REFERRED TO AS "OWNERS" (WHETHER ONE OR MORE) OF THE 0.2296 ACRES TRACT DESCRIBED IN THE ABOVE AND FOREGOING MAP OF VIEWS AT GREGG, DO HEREBY MAKE AND ESTABLISH SAID SUBDIVISION AND DEVELOPMENT PLAN OF SAID PROPERTY ACCORDING TO ALL LINES, DEDICATIONS, RESTRICTIONS, AND NOTATIONS ON SAID MAPS OR PLAT AND HEREBY DEDICATE TO THE USE OF THE PUBLIC FOREVER, ALL STREETS (EXCEPT THOSE STREETS DESIGNATED AS PRIVATE STREETS, OR PERMANENT ACCESS EASEMENTS), ALLEYS, PARKS, WATER COURSES, DRAINS, EASEMENTS AND PUBLIC PLACES SHOWN THEREON FOR THE PURPOSES AND CONSIDERATIONS THEREIN EXPRESSED; AND DO HEREBY BIND OURSELVES, OUR HEIRS, SUCCESSORS AND ASSIGNS TO WARRANT AND FOREVER DEFEND THE TITLE ON THE LAND SO DEDICATED.

FURTHER, OWNERS HAVE DEDICATED AND BY THESE PRESENTS DO DEDICATE TO THE USE OF THE PUBLIC FOR PUBLIC UTILITY PURPOSE FOREVER UNOBSTRUCTED AERIAL EASEMENTS. THE AERIAL EASEMENTS SHALL EXTEND HORIZONTALLY AN ADDITIONAL ELEVEN FEET, SIX INCHES (11' 6") FOR TEN FEET (10' 0") PERMETER GROUND EASEMENTS OR SEVEN FEET, SIX INCHES (7' 6") FOR FOURTEEN FEET (14' 0") PERMETER GROUND EASEMENTS OR FIVE FEET, SIX INCHES (5' 6") FOR SIXTEEN FEET (16' 0") PERMETER GROUND EASEMENTS, FROM A PLANE SIXTEEN FEET (16' 0") ABOVE THE GROUND LEVEL UPWARD, LOCATED ADJACENT TO AND ADJOINING SAID PUBLIC UTILITY EASEMENTS THAT ARE DESIGNATED WITH AERIAL EASEMENTS (U.E. AND A.E.) AS INDICATED AND DEPICTED HEREON, WHEREBY THE AERIAL EASEMENT TOTALS TWENTY ONE FEET, SIX INCHES (21' 6") IN WIDTH.

FURTHER, OWNERS HAVE DEDICATED AND BY THESE PRESENTS DO DEDICATE TO THE USE OF THE PUBLIC FOR PUBLIC UTILITY PURPOSE FOREVER UNOBSTRUCTED AERIAL EASEMENTS. THE AERIAL EASEMENTS SHALL EXTEND HORIZONTALLY AN ADDITIONAL TEN FEET (10' 0") FOR TEN FEET (10' 0") BACK-TO-BACK GROUND EASEMENTS, OR EIGHT FEET (8' 0") FOR FOURTEEN FEET (14' 0") BACK-TO-BACK GROUND EASEMENTS OR SEVEN FEET (7' 0") FOR SIXTEEN FEET (16' 0") BACK-TO-BACK GROUND EASEMENTS, FROM A PLANE SIXTEEN FEET (16' 0") ABOVE THE GROUND LEVEL UPWARD, LOCATED ADJACENT TO BOTH SIDES AND ADJOINING SAID PUBLIC UTILITY EASEMENTS THAT ARE DESIGNATED WITH AERIAL EASEMENTS (U.E. AND A.E.) AS INDICATED AND DEPICTED HEREON, WHEREBY THE AERIAL EASEMENT TOTALS THIRTY FEET (30' 0") IN WIDTH.

FURTHER, OWNERS DO HEREBY DECLARE THAT ALL PARCELS OF LAND DESIGNATED AS LOTS ON THIS PLAT ARE ORIGINALLY INTENDED FOR CONSTRUCTION OF SINGLE FAMILY RESIDENTIAL DWELLING UNITS THEREON AND SHALL BE RESTRICTED FOR SAME UNDER THE TERMS AND CONDITIONS OF SUCH RESTRICTIONS FILED SEPARATELY.

FURTHER, OWNERS DO HEREBY COVENANT AND AGREE THAT ALL OF THE PROPERTY WITHIN THE BOUNDARIES OF THIS PLAT IS HEREBY RESTRICTED TO PREVENT THE DRAINAGE OF ANY SEPTIC TANKS INTO ANY PUBLIC OR PRIVATE STREET, PERMANENT ACCESS EASEMENT, ROAD OR ALLEY, OR ANY DRAINAGE DITCH, EITHER DIRECTLY OR INDIRECTLY.

FURTHER, OWNERS DO HEREBY DEDICATE TO THE PUBLIC A STRIP OF LAND FIFTEEN FEET (15' 0") WIDE ON EACH SIDE OF THE CENTER LINE OF ANY AND ALL BAYOUS, CREEKS, CULLIES, RAVINES, DRAWS, SLOUGHS OR OTHER NATURAL DRAINAGE COURSES LOCATED IN SAID PLAT, AS EASEMENTS FOR DRAINAGE PURPOSES, GIVING THE CITY OF HOUSTON, HARRIS COUNTY, OR ANY OTHER GOVERNMENTAL AGENCY, THE RIGHT TO ENTER UPON SAID EASEMENT AT ANY AND ALL TIMES FOR THE PURPOSE OF CONSTRUCTION AND MAINTENANCE OF DRAINAGE FACILITIES AND STRUCTURES.

FURTHER, OWNERS DO HEREBY COVENANT AND AGREE THAT ALL OF THE PROPERTY WITHIN THE BOUNDARIES OF THIS PLAT AND ADJACENT TO ANY DRAINAGE EASEMENT, DITCH, GULLY, CREEK OR NATURAL DRAINAGE WAY SHALL HEREBY BE RESTRICTED TO KEEP SUCH DRAINAGE WAYS AND EASEMENTS CLEAR OF FENCES, BUILDINGS, PLANTING AND OTHER OBSTRUCTIONS TO THE OPERATIONS AND MAINTENANCE OF THE DRAINAGE FACILITY AND THAT SUCH ADJUTING PROPERTY SHALL NOT BE PERMITTED TO DRAIN DIRECTLY INTO THIS EASEMENT EXCEPT BY MEANS OF AN APPROVED DRAINAGE STRUCTURE.

FURTHER, OWNERS HEREBY CERTIFY THAT THIS REPLAT DOES NOT ATTEMPT TO ALTER, AMEND, OR REMOVE ANY COVENANTS OR RESTRICTIONS. WE FURTHER CERTIFY THAT NO PORTION OF THE PRECEDING PLAT WAS LIMITED BY DEED RESTRICTION TO RESIDENTIAL USE FOR NOT MORE THAN TWO (2) RESIDENTIAL UNITS PER LOT.

WITNESS MY HAND IN THE CITY OF HOUSTON, TEXAS, THIS 30 DAY OF October, 2025.

By: *Angbeen Saeed*
ANGBEEN SAEED

STATE OF TEXAS
COUNTY OF HARRIS

BEFORE ME, THE UNDERSIGNED AUTHORITY, ON THIS DAY PERSONALLY APPEARED ANGBEEN SAEED, KNOWN TO ME TO BE THE PERSON WHOSE NAME IS SUBSCRIBED TO THE FOREGOING INSTRUMENT, ACKNOWLEDGED TO ME THAT HE EXECUTED THE SAME FOR THE PURPOSES AND CONSIDERATIONS THEREIN EXPRESSED.

GIVEN UNDER MY HAND AND SEAL OF OFFICE, THIS 30 DAY OF October, 2025.



NOTARY PUBLIC IN AND FOR THE STATE OF TEXAS
MY COMMISSION EXPIRES: 09/24/2029

I, PIOTR A. DEBSKI AM AUTHORIZED UNDER THE LAWS OF THE STATE OF TEXAS TO PRACTICE THE PROFESSION OF SURVEYING AND HEREBY CERTIFY THAT THE ABOVE SUBDIVISION IS TRUE AND ACCURATE, WAS PREPARED FROM AN ACTUAL SURVEY OF THE PROPERTY MADE UNDER MY SUPERVISION ON THE GROUND; THAT, EXCEPT AS SHOWN ALL BOUNDARY CORNERS, ANGLE POINTS, POINTS OF CURVATURE AND OTHER POINTS OF REFERENCE, HAVE BEEN MARKED WITH IRON (OR OTHER OBJECTS OF PERMANENT NATURE) PIPES OR RODS HAVING AN OUTSIDE DIAMETER OF NOT LESS THAN FIVE EIGHTHS (5/8) INCH AND A LENGTH OF NOT LESS THAN THREE (3) FEET; AND THAT THE PLAT BOUNDARY CORNERS HAVE BEEN TIED TO THE TEXAS COORDINATE SYSTEM OF 1983, (SOUTH CENTRAL) ZONE.

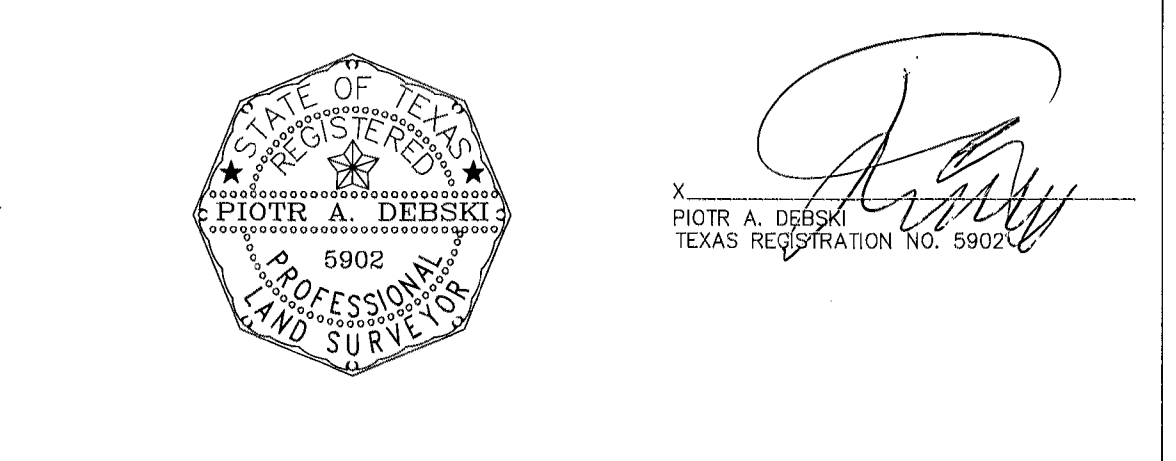

THIS IS TO CERTIFY THAT THE PLANNING COMMISSION OF THE CITY OF HOUSTON, TEXAS, HAS APPROVED THIS PLAT AND SUBDIVISION OF VIEWS AT GREGG IN CONFORMANCE WITH THE LAWS OF THE STATE OF TEXAS AND THE ORDINANCES OF THE CITY OF HOUSTON, AS SHOWN HEREON, AND AUTHORIZED THE RECORDING OF THIS PLAT THIS 25 DAY OF November, 2025.

BY: *Lisa M. Clark*
LISA M. CLARK, CHAIR OR BY: *M. Sotary Garza*
M. SOTARY GARZA, VICE CHAIRMAN

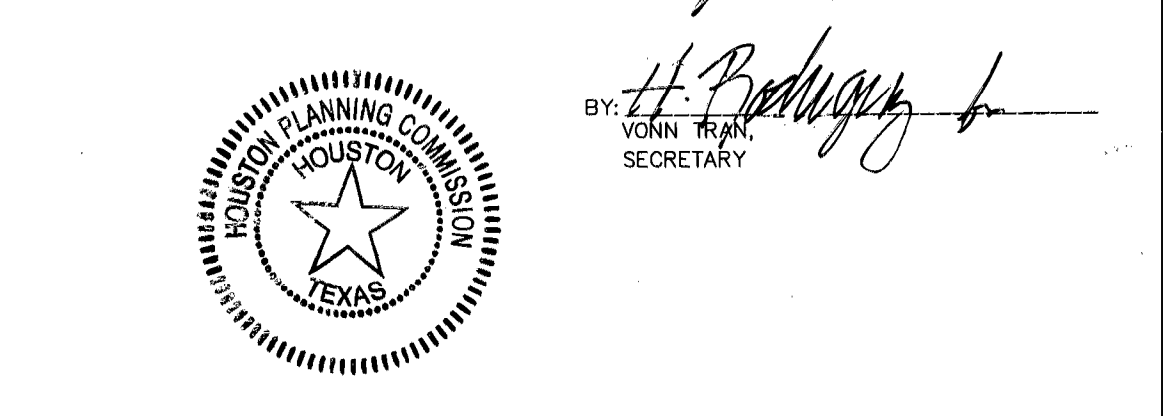

I, TENESHA HUDSPETH, COUNTY CLERK OF HARRIS COUNTY, DO HEREBY CERTIFY THAT THE WITHIN AND SUBDIVISION OF VIEWS AT GREGG IN CONFORMANCE WITH THE LAWS OF THE STATE OF TEXAS AND THE ORDINANCES OF THE CITY OF HOUSTON, AS SHOWN HEREON, AND AUTHORIZED THE RECORDING OF THIS PLAT THIS 25 DAY OF November, 2025, AT 10:00 O'CLOCK A.M., AND DULY RECORDED ON Dec 1, 2025, AT 2:11 O'CLOCK P.M., AND AT FILM CODE NUMBER 115881 OF THE MAP RECORDS OF HARRIS COUNTY FOR SAID COUNTY.

WITNESS MY HAND AND SEAL OF OFFICE, AT HOUSTON, THE DAY AND DATE LAST ABOVE WRITTEN.

TENESHA HUDSPETH
COUNTY CLERK
OF HARRIS COUNTY, TEXAS

BY: *Jazlyn Gordova*
JAZLYN GORDOVA
DEPUTY



OFFICE OF
TENESHA HUDSPETH
COUNTY CLERK, HARRIS COUNTY, TEXAS
MAP RECORDS OF COUNTY CLERK

VIEWS AT GREGG
FILM CODE 713837
THIS IS PAGE 1 OF 2 PAGES
SCANNER Context 104600
KEY MAP

- PLAT NOTES:**
- UNLESS OTHERWISE INDICATED, THE BUILDING LINES, WHETHER ONE OR MORE, SHOWN ON THIS SUBDIVISION PLAT ARE ESTABLISHED TO EVIDENCE COMPLIANCE WITH THE APPLICABLE PROVISIONS OF CHAPTER 42, CODE OF ORDINANCES, CITY OF HOUSTON, TEXAS, IN EFFECT AT THE TIME THIS PLAT WAS APPROVED, WHICH MAY BE AMENDED FROM TIME TO TIME.
 - AT LEAST 150 SQUARE FEET OF PERMEABLE AREA IS REQUIRED PER LOT. 750 S.F. OF PERMEABLE AREA SHALL BE PROVIDED WITHIN THE BOUNDARY OF THIS SUBDIVISION. REFERENCE 42-1 PERMEABLE AREA DEFINITION.
 - ALL LOTS SHALL HAVE ADEQUATE WASTEWATER COLLECTION SERVICES.
 - NO BUILDING PERMIT OR OTHER PERMIT, EXCEPT PERMITS FOR CONSTRUCTION OF PUBLIC IMPROVEMENTS, WILL BE ISSUED BY THE CITY OF HOUSTON, TEXAS, FOR CONSTRUCTION WITHIN THE SUBDIVISION UNTIL SUCH TIME AS THE FUNDS REQUIRED UNDER PROVISIONS OF SECTION 42-253 OF THE CODE OF ORDINANCES OF THE CITY OF HOUSTON, TEXAS, HAS BEEN SUBMITTED AND ACCEPTED BY THE CITY.
 - NO LAND IS BEING ESTABLISHED AS PRIVATE PARK OR DEDICATED TO THE PUBLIC FOR PARK PURPOSES.
 - THIS PROPERTY IS LOCATED IN PARK SECTOR NUMBER 17.
 - THIS PERCENTAGE IS 100% SHALL BE APPLIED TO THE THEN-CURRENT FEE IN LIEU OF DEDICATION.
 - THE THEN-CURRENT FEE IN LIEU OF DEDICATION SHALL BE APPLIED TO INCREMENTAL (PROPOSED MINUS EXISTING) DWELLING UNITS.
 - THE COORDINATES SHOWN HEREON ARE TEXAS SOUTH CENTRAL ZONE NO. 4204 STATE PLAN GRID COORDINATE (NAD83) AND MAY BE BROUGHT TO SURFACE BY APPLYING THE FOLLOWING COMBINED SCALE 0.99999591.
 - ABSENT WRITTEN AUTHORIZATION BY THE AFFECTED UTILITIES, ALL UTILITY AND AERIAL EASEMENTS MUST BE KEPT UNOBSTRUCTED FROM ANY NON-UTILITY IMPROVEMENTS OR OBSTRUCTIONS BY THE PROPERTY OWNER. ANY UNAUTHORIZED IMPROVEMENTS OR OBSTRUCTIONS MAY BE REMOVED BY ANY PUBLIC UTILITY AT THE PROPERTY OWNER'S EXPENSE. WHILE WOODEN POSTS AND PANELED WOODEN FENCES ALONG THE PERIMETER AND BACK TO BACK EASEMENTS AND ALONGSIDE REAR LOTS LINES ARE PERMITTED, THEY TOO MAY BE REMOVED BY PUBLIC UTILITIES AT THE PROPERTY OWNER'S EXPENSE SHOULD THEY BE AN OBSTRUCTION TO PUBLIC UTILITIES MAY PUT SAID WOODEN POSTS AND PANELED WOODEN FENCES BACK UP, BUT GENERALLY WILL NOT REPLACE WITH NEW FENCING.
 - THE BUILDING LINE FOR PROPERTY ADJACENT TO TWO INTERSECTING STREETS SHALL NOT ENCRDACH INTO ANY VISIBILITY TRIANGLE. THIS AREA SHALL ASSURE ADEQUATE VISIBILITY SIGHT LINES FOR VEHICULAR TRAFFIC APPROACHING THE INTERSECTION. THE MAXIMUM HEIGHT OF THE VISIBILITY TRIANGLE SHALL BE 20 FEET AS MEASURED VERTICALLY FROM THE GROUND.
 - SINGLE FAMILY RESIDENTIAL SHALL MEAN THE USE OF A LOT WITH ONE BUILDING DESIGNED FOR AND CONTAINING NOT MORE THAN TWO SEPARATE UNITS WITH FACILITIES FOR LIVING, SLEEPING, COOKING, AND EATING THEREIN. A LOT UPON WHICH IS LOCATED A FREE-STANDING BUILDING CONTAINING ONE DWELLING UNIT AND A DETACHED SECONDARY DWELLING UNIT OF NOT MORE THAN 900 SQUARE FEET ALSO SHALL BE CONSIDERED SINGLE FAMILY RESIDENTIAL. A BUILDING THAT CONTAINS ONE DWELLING UNIT ON ONE LOT THAT IS CONNECTED BY A PARTY WALL TO ANOTHER BUILDING CONTAINING ONE DWELLING UNIT ON AN ADJACENT LOT SHALL BE SINGLE FAMILY RESIDENTIAL.
 - EACH LOT SHALL PROVIDE A MINIMUM OF TWO OFF-STREET PARKING SPACES PER DWELLING UNIT ON EACH LOT. IN THOSE INSTANCES WHERE A SECONDARY UNIT IS PROVIDED ONLY ONE ADDITIONAL SPACE SHALL BE PROVIDED
 - THE NUMBER OF SINGLE-FAMILY RESIDENTIAL DWELLING UNITS THAT CAN BE CONSTRUCTED SHALL NOT EXCEED AN EQUIVALENT DENSITY OF 27 UNITS TO THE GROSS ACRE OF ALL LAND WITHIN THE BOUNDARIES OF THIS SUBDIVISION PLAT.

DWELLING UNIT DENSITY TABLE

DWELLING UNITS	TOTAL GROSS ACREAGE	TOTAL PROJ. DENSITY (UNITS PER AC.)
5	0.2296 ACRES	21.77

PARKS AND OPEN SPACE TABLE

A	I HEREBY CERTIFY THAT THE INFORMATION PROVIDED IS TRUE	
B	NUMBER OF EXISTING DWELLING UNITS (DU)	0
C	NUMBER OF PROPOSED DU	5
D	INCREMENTAL NUMBER OF DU (C-B)	5

VIEWS AT GREGG

A SUBDIVISION OF 0.2296 ACRES (10,000 SQUARE FEET) OF LAND, BEING A REPLAT OF LOTS 1 AND 2, BLOCK 3, OF STAPLES & McLELLANDS ADDITION, A SUBDIVISION IN HARRIS COUNTY, TEXAS, ACCORDING TO MAP OR PLAT THEREOF RECORDED IN VOLUME 48, PAGE 53 OF THE H.C.D.R., HARRIS COUNTY, TEXAS.

REASON FOR REPLAT: TO CREATE FIVE (5) SINGLE FAMILY RESIDENTIAL LOTS

LOTS: 5 BLOCK: 1

OCTOBER, 2025

OWNER
ANGBEEN SAEED

ENGINEERS & DEVELOPMENT CONSULTANTS
T.B.P.E. FIRM # 19146
INQUIRY@CEENGINEERS.COM
www.CEENGINEERS.com
(O): 832-491-1458
CE ENGINEERS & DEVELOPMENT CONSULTANTS, INC.
(CEEDC PROJ 23-1088)

RECORDER'S MEMORANDUM:
At the time of recording, this instrument was found to be in compliance with the Texas Planning Commission's requirements for legibility, color or photo copy, discoloration, etc. All handwritten additions and changes were reviewed in the presence of the recorder and recorded.