

Stephen R. Miley
Nancy Miley

WEDGEWOOD FOREST DRIVE
 (80' R.O.W.)

- NOTES:
- 1.) SUBJECT TO ANY AND ALL RESTRICTIVE COVENANTS IN CABINET C, SHEET 66 M.C.M.R. AND VOLUME 991, PAGE 717 AND VOLUME 1070, PAGE 51 M.C.D.R. AND M.C.C.F. NOS. 8000551, 8014440, 8023313 AND 8113903.
 - 2.) 10' R.O.W. AND EASEMENT (FRONT AND REAR LOT LINES) AND 5' R.O.W. AND EASEMENT (SIDE LOT LINES) IN M.C.C.F. NO 2000551.

Stephen R. Miley
 STEPHEN R. MILEY
Nancy Miley by Stephen R. Miley
 NANCY MILEY, by her Attorney-In-Fact STEPHEN R. MILEY
 APRIL 7, 1997

THE SURVEYOR HAS NOT ABSTRACTED THE SUBJECT PROPERTY. SUBJECT PROPERTY IS BASED ON TITLE COMMITMENT LISTED BELOW. ALL BEARINGS SHOWN ARE REFERENCED PER RECORDED PLAN OF SAID SUBDIVISION.

LOT:	BLOCK:	SUBDIVISION:	SECTION:
1	6	THE WOODLANDS, VILLAGE OF PANTHER CREEK	II
COUNTY:	STATE:	RECORDATION:	SURVEY:
MONTGOMERY	TEXAS	CABINET C, SHEET 66 M.C.M.R.	-
PURCHASER:		FIELD WORK:	FINAL CHECK:
STEPHEN R. MILEY AND WIFE NANCY MILEY		03-31-97 / B.W.	04-01-97 / S.B.
ADDRESS:		DRAFTING:	KEY MAP:
1 EAST WEDGEWOOD GLEN, THE WOODLANDS, TEXAS		04-01-97 / J.A.	251 E



ALLTEX
 REALTY SERVICES
 REAL ESTATE SURVEY DIVISION
 9625 KATT FREEWAY, SUITE 420
 HOUSTON, TEXAS 77024
 TEL: (713) 468-7707
 FAX: (713) 468-8815

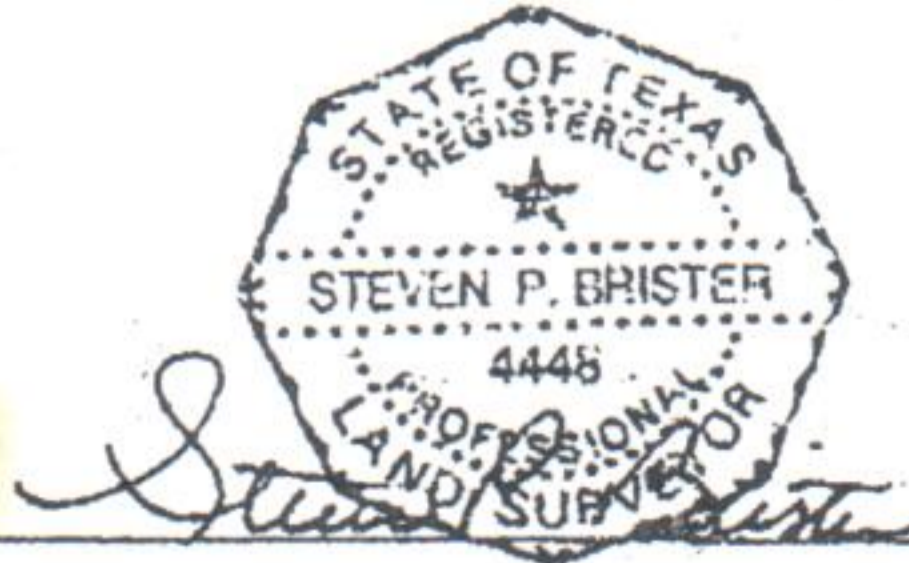

I DO HEREBY CERTIFY THAT THIS SURVEY WAS THIS DAY MADE ON THE GROUND OF THE PROPERTY LEGALLY DESCRIBED HEREON IS CORRECT AND THERE ARE NO ENCROACHMENTS EXCEPT AS SHOWN HEREON.

• Subject Property IS NOT Located in
 a Federal Insurance Administration Designated Flood
 Hazard Area. ZONE "X"
 As per map 480483
 Panel DS40 F Dated DEC. 20, 1996

• THIS INFORMATION IS BASED ON GRAPHIC PLOTTING ONLY. WE DO NOT ASSUME RESPONSIBILITY FOR EXACT DETERMINATION.

MORT. CO.	D AND N FINANCIAL
TITLE CO.	MONTGOMERY COUNTY TITLE
CLF. NO.	97030588
JOB NO.	97 - 00246
REV. DATE	4-3-97