

SCALE: 1" = 300'
 COUNTY: HENDERSON
 ACREAGE: 16.85 AC.

SURVEY: R. C. MORRIS A-546
 DESCRIPTION: 2013-00005761
 SURVEYED FOR: NOAH SHERFIELD

I, Mark Ferrell, Registered Professional Land Surveyor 4373, do hereby certify that the above survey plat and notes of events do represent the results of an on the ground survey made under my direction and supervision.
 This the 17th Day of March, 2014.

HEARN SURVEYING ASSOCIATES

FIRM NO. 10019900
 201 HWY. 175, STE. 2
 ATHENS, TX 75751
 (903) 675-2858

1-800-432-7670

Mark Ferrell
 Registered Professional Land Surveyor
 Number 4373

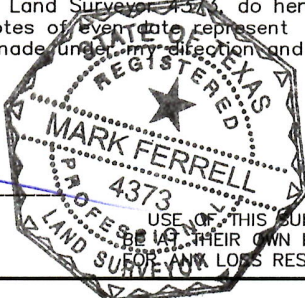

USE OF THIS SURVEY FOR ANY OTHER PURPOSE OR BY OTHER PARTIES SHALL BE AT THEIR OWN RISK AND THE UNDERSIGNED SURVEYOR IS NOT RESPONSIBLE FOR ANY LOSS RESULTING THEREFROM.

FIELD NOTES

SHERFIELD TRACT
16.85 ACRES

R.C.MORRIS SURVEY
ABSTRACT 546

HENDERSON COUNTY

All that certain lot, tract, or parcel of land situated in the R.C.Morris Survey Abstract 546, Henderson County, Texas, and being part of a called 17.38 acre tract of land described by deed recorded in Instrument 2013-00005761 of the Official Records of Henderson County, Texas. Said tract or parcel of land being more fully described by metes and bounds as follows.

BEGINNING on a found 1/2" iron rod for the southwest corner of this tract and the southwest corner of the above mentioned 17.38 acre tract, said point being the southeast corner of the Sherfield Tract recorded in Volume 2130, Page 699;

THENCE N00°02'29"W 849.92 feet to the northwest corner of this tract; Witness: S00°02'29"E 2.3 feet, a found 1/2" iron rod.

THENCE EAST 870.78 feet to a set 1/2" iron rod for the northeast corner of this tract and the northwest corner of a 40 foot strip recorded in Volume 1058, Page 525; Witness: EAST 40.0 feet, a found concrete monument for the northwest corner of the Williams 26.068 acre tract recorded in Volume 1158, Page 522.

THENCE with the west line of said 40 foot strip and the east line of this tract S00°55'51"W 849.95 feet to a set 1/2" iron rod for the southeast corner of this tract;

THENCE S89°59'39"W 856.37 feet to the place of beginning and containing 16.85 acres of land.

SURVEYOR'S CERTIFICATE

I, Mark Ferrell, Registered Professional Land Surveyor 4373, do hereby certify that I directed an on the ground survey of the property described above and prepared the above field notes and plat of even date describing the boundaries of same just as they were found and surveyed upon the ground.

Witness my hand and seal at Athens, Texas, this the 17th day of March, 2014.

Mark Ferrell
Registered Professional Land
Surveyor Number 4373
Firm No. 10019900

