

COTTON VALLEY LANE  
(60' R.O.W.)

*Courtney Ernst*  
06/30/2025

NOTES:

1. ALL BEARINGS SHOWN HEREON ARE BASED ON THE RECORDED PLAT.
2. SUBJECT TO APPLICABLE RESTRICTIVE COVENANTS LISTED IN ITEM No. 1, SCHEDULE "B" OF TITLE COMMITMENT ISSUED BY FIRST AMERICAN TITLE INSURANCE COMPANY UNDER G.F. No. 150-120200993-339.

FLOOD MAP:

THIS PROPERTY LIES IN ZONE "X" AS DEPICTED ON COMMUNITY PANEL No. 48339 C 0730 G, DATED: 12-19-96

THIS INFORMATION IS BASED ON GRAPHIC PLOTTING. WE DO NOT ASSUME RESPONSIBILITY FOR EXACT DETERMINATION.

PLAT OF SURVEY

SCALE: 1" = 20'

© 2012, ALLPOINTS SERVICES, CORP., All Rights Reserved. This original work is protected under copyright laws. Title 17 U.S. Code Sections 101 & 102. All violators will be prosecuted to the extent of the law. This survey is being provided solely for the use of the recipients and no license has been created, express or implied, to copy this survey except as is necessary in conjunction with the original inspection.

FOR: DRHORTON  
ADDRESS: 21515 COTTON VALLEY LANE  
ALLPOINTS JOB #: DR43154 JF  
G.F.: 150-120200993-339

LOT 14, BLOCK 2,  
VALLEY RANCH, SECTION 5,  
CAB. "Z", SHTS. 652-653, MAP RECORDS,  
MONTGOMERY COUNTY, TEXAS

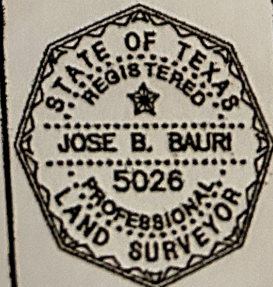

I HEREBY CERTIFY THAT THIS PLAT REPRESENTS THE RESULTS OF A SURVEY MADE ON THE GROUND, ON THE 11th DAY OF SEPTEMBER, 2012.

*Jose B. Bauri*