

**Building Sketch**

Borrower/Client	LAGUNAS, ERIKA & RENE		
Property Address	16734 Warbler Dr		
City	Conroe	County	MONTGOMERY
		State	TX
		Zip Code	77385
Lender	CORNERSTONE HOME LENDING, INC.		

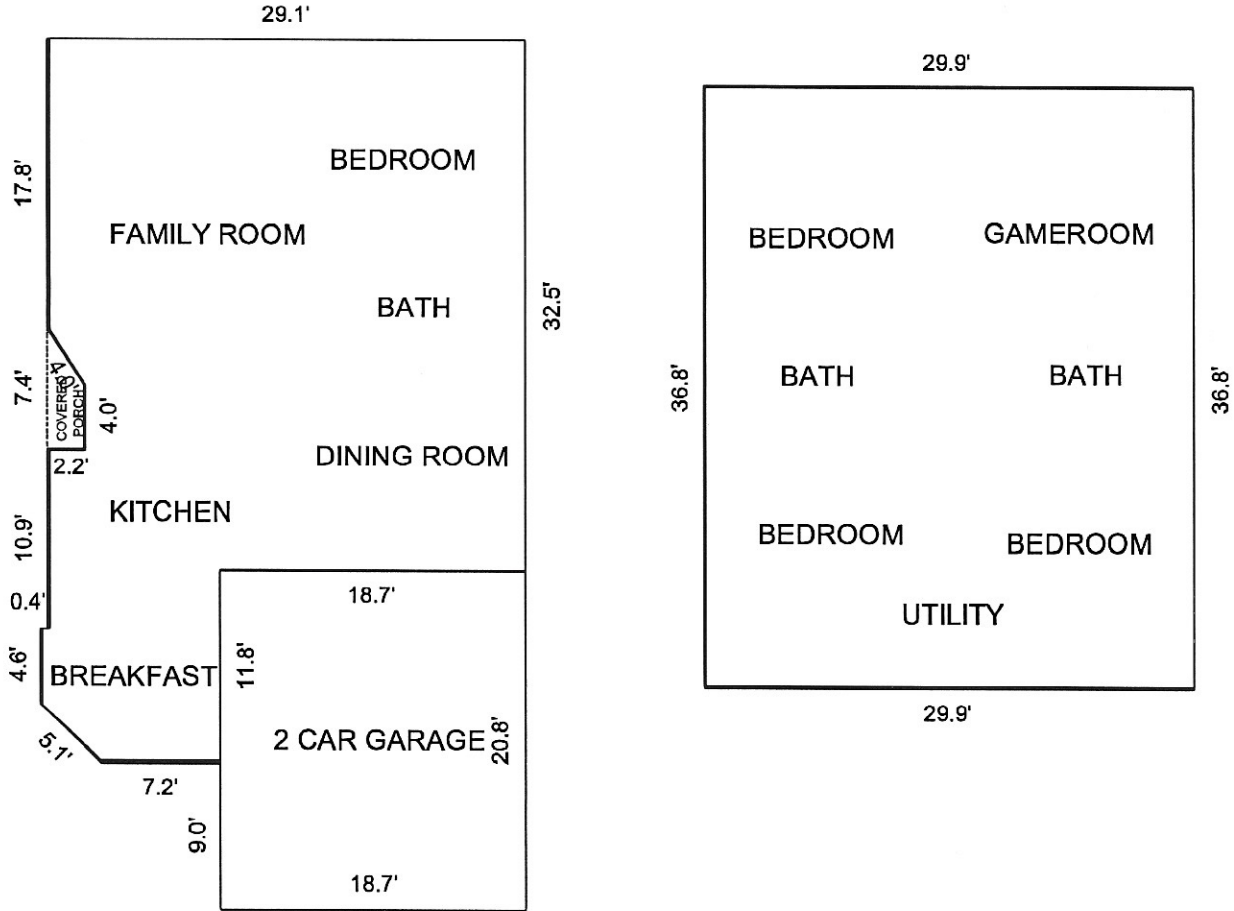

Sketch by Apex IV™

Comments:

AREA CALCULATIONS SUMMARY			
Code	Description	Size	Net Totals
GLA1	First Floor	1052.73	1052.73
GLA2	Second Floor	1100.32	1100.32
P/P	Covered Porch	12.54	12.54
GAR	Garage	388.96	388.96
TOTAL LIVABLE (rounded)			2153

LIVING AREA BREAKDOWN			
Breakdown			Subtotals
<b>First Floor</b>			
	17.8 x	29.1	517.98
0.5 x	2.2 x	3.4	3.74
0.5 x	3.6 x	3.6	6.48
	3.6 x	4.6	16.56
	3.2 x	10.9	34.88
	7.2 x	19.1	137.52
	7.4 x	8.2	60.68
	14.7 x	18.7	274.89
<b>Second Floor</b>			
	29.9 x	36.8	1100.32
9 Calculations Total (rounded)			2153