

N 00° 58' 31" E - 286.15'

S 88° 35' 20" E - 284.68'

N 88° 40' 41" W - 233.06'

LOT 7
1.8180 ACRES

FND 1/2" I.R.

FND 1/2" I.R.

FND 1/2" I.R.

15' U.E.

15' U.E.

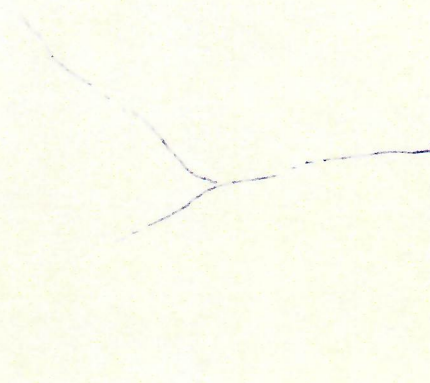
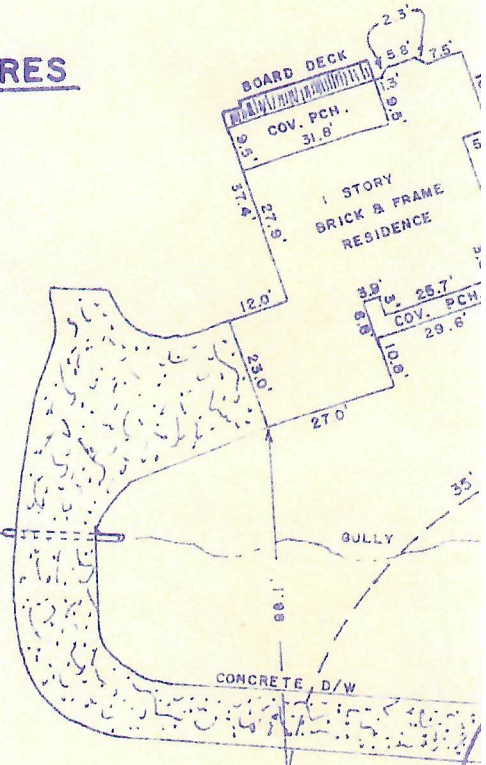
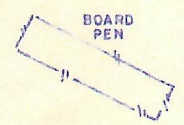

I do hereby certify, to the best of my knowledge, information, and belief, that this plat represents an actual survey made on the ground by me, and that there are no shortages, conflicts, or encroachments other than shown. This survey conforms to the current Texas Surveyors Association Standards and Specifications for a Category 1A, Condition 3 Survey.

Gerald L. Reinke

GERALD L. REINKE, R.P.S. No. 3971



PLAT PREPARED FOR:
Robert G. & Sharon L. Steffen
26530 Pin Oak Dr.

Curve Data

R = 50.00'

$\Delta = 89^\circ 54' 10''$

L = 78.46'

Ch. = S $46^\circ 15' 45''$ W - 70.65'

PIN OAK DR.
(60' R.O.W.)

Plat Showing Survey of 1.8180 Acres
Being Lot 7, RUSTIC OAKS
Plat Recorded in Cabinet C, Sheets 9 & 10, M.C.M.R.
IN THE
Bartley Murray Survey, A-343
Montgomery County, Texas
Scale 1"=40' December 26, 1984

BY

T-47.1 RESIDENTIAL REAL PROPERTY DECLARATION IN LIEU OF AFFIDAVIT
(Provided in accordance with Texas Civil Practice and Remedies Code Section 132.001)

Date: 12/12/25 GF No. _____
Declarant: Sharon Steffen
Description of Property: 26530 Pin Oak Dr
County Montgomery, Texas
Date of Survey: 12/26/1984

"Title Company" as used herein is the Title Insurance Company whose policy of title insurance is issued in reliance upon the statements contained herein.

The undersigned declares as follows:

1. I am an owner of the Property. (Or state other basis for knowledge of the Property, such as lease, management, neighbor, etc. For example, "Declarant is the manager of the Property for the record title owners.")
2. I am familiar with the property and the improvements located on the Property.
3. I am closing a transaction requiring title insurance and the proposed insured owner or lender has requested area and boundary coverage in the title insurance policy(ies) to be issued in this transaction. I understand that the Title Company may make exceptions to the coverage of the title insurance as Title Company may deem appropriate. I understand that the owner of the property, if the current transaction is a sale, may request a similar amendment to the area and boundary coverage in the Owner's Policy of Title Insurance upon payment of the promulgated premium.
4. To the best of my actual knowledge and belief, since the Date of the Survey, there have been no:
 - a. construction projects such as new structures, additional buildings, rooms, garages, swimming pools, deckings, or other permanent improvements or fixtures;
 - b. changes in the location of boundary fences or boundary walls;
 - c. construction projects on immediately adjoining property(ies) which construction occurred on or near the boundary of the Property;
 - d. conveyances, replattings, easement grants and/or easement dedications(such as a utility line) by any party affecting the Property.

EXCEPT for the following (If None, Insert "None" Below):

n/a

5. I understand that Title Company is relying on the truthfulness of the statements made in this Declaration to provide the area and boundary coverage and upon the evidence of the existing real property survey of the Property. This Declaration is not made for the benefit of any other parties and does not constitute a warranty or guarantee of the location of improvements.

6. I understand that I have no liability to Title Company should the information in this Declaration be incorrect other than information that I personally know to be incorrect and which I do not disclose to the Title Company.
7. ALL STATEMENTS IN THIS DECLARATION ARE TRUE TO THE BEST OF MY KNOWLEDGE. I UNDERSTAND THAT ANY PERSON INTENTIONALLY MAKING A FALSE STATEMENT MAY BE LIABLE FOR ACTUAL AND/OR PUNITIVE DAMAGES.

<p>My name is <u>Sharon Steffen</u> My date of birth is _____ and my address is _____ _____</p> <p>I declare under penalty of perjury that the foregoing is true and correct.</p> <p>Executed in <u>Montgomery</u> County, State of <u>TEXAS</u>, on the <u>12</u> day of <u>December</u>, <u>2015</u>.</p> <p>Signed:  Declarant</p>	<p>My name is _____ My date of birth is _____ and my address is _____ _____</p> <p>I declare under penalty of perjury that the foregoing is true and correct.</p> <p>Executed in _____ County, State of _____, on the _____ day of _____, _____.</p> <p>Signed: _____ Declarant</p>
---	---