

FLOORPLAN

Borrower: JASON BURTON	File No.: 07100285
Property Address: 16118 UNION POINTE COURT	Case No.: 9365616
City: CYPRESS	State: TX
Lender: FLAGSTAR BANK/LSI	Zip: 77429-8174

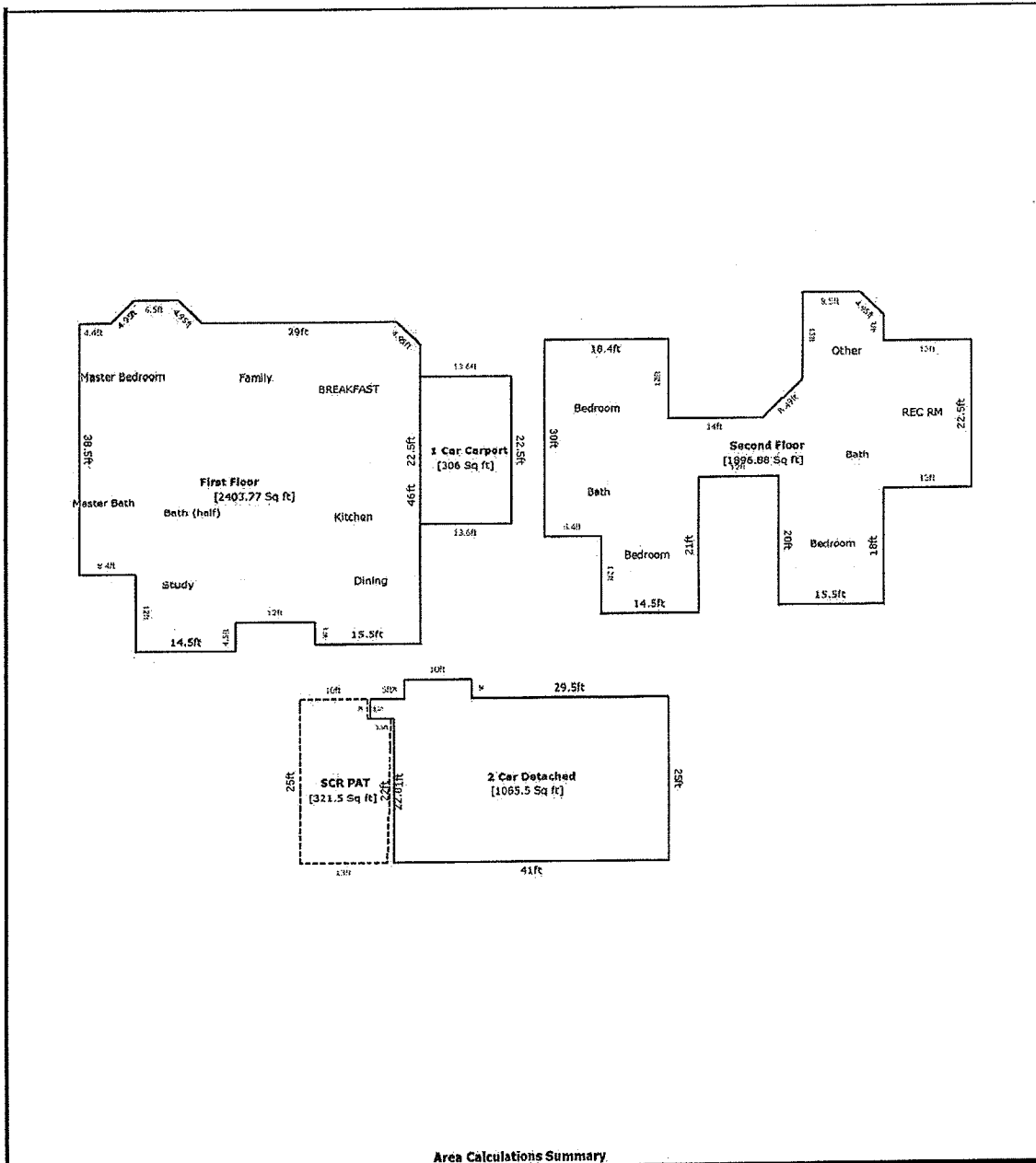

Area Calculations Summary

Living Area	
First Floor	2403.8 Sq ft
Second Floor	1896.9 Sq ft
Total Living Area (Rounded):	4301 Sq ft
Non-living Area	
1 Car Carport	306 Sq ft
SCR PAT	321.5 Sq ft
2 Car Detached	1065.5 Sq ft

FLOORPLAN

Borrower: JASON BURTON	File No.: 07100285
Property Address: 16118 UNION POINTE COURT	Case No.: 9365616
City: CYPRESS	State: TX
Lender: FLAGSTAR BANK/LSI	Zip: 77429-8174

Area Calculations Summary		
Living Area		Calculation Details
First Floor	2403.8 Sq ft	$0.5 \times 3.5 \times 3.5 = 6.125$ $0.5 \times 3.5 \times 3.5 = 6.125$ $6.5 \times 3.5 = 22.75$ $14.5 \times 4.5 = 65.25$ $15.5 \times 3.5 = 54.25$ $38.5 \times 8.4 = 323.4$ $42 \times 42.5 = 1785$ $3.5 \times 38.5 = 134.75$ $0.5 \times 3.5 \times 3.5 = 6.125$
Second Floor	1896.9 Sq ft	$22.5 \times 13 = 292.5$ $14.5 \times 12 = 174$ $15.5 \times 20 = 310$ $22.9 \times 9 = 206.1$ $50.4 \times 9 = 453.6$ $18.4 \times 12 = 220.8$ $0.5 \times 6 \times 6 = 18$ $12 \times 6 = 72$ $12 \times 9.5 = 114$ $0.5 \times 3.5 \times 3.5 = 6.125$ $8.5 \times 3.5 = 29.75$
Total Living Area (Rounded):	4301 Sq ft	
Non-living Area		
1 Car Carport	306 Sq ft	$22.5 \times 13.6 = 306$
SCR PAT	321.5 Sq ft	$25 \times 10 = 250$ $22 \times 3 = 66$ $0.5 \times 22 \times 0.5 = 5.5$
2 Car Detached	1065.5 Sq ft	$10 \times 3 = 30$ $3 \times 3.5 = 10.5$ $41 \times 25 = 1025$