

Building Sketch (Page - 1)

Borrower	JoAnne Johnson				
Property Address	15 Atrium Woods Ct				
City	Spring	County	Montgomery	State	TX Zip Code 77381
Lender/Client	JoAnne Johnson				

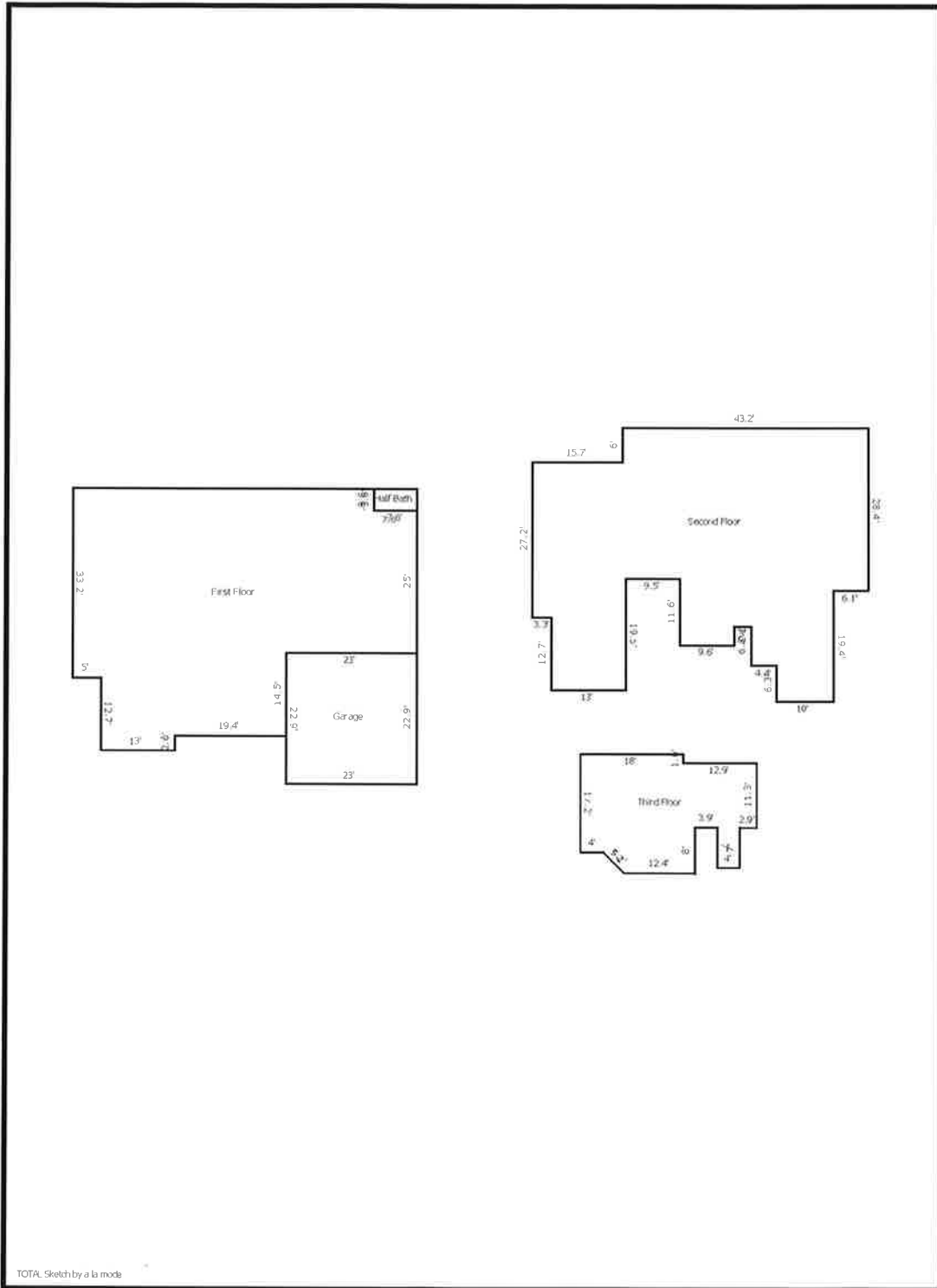

Building Sketch (Page - 2)

Borrower	JoAnne Johnson				
Property Address	15 Atrium Woods Ct				
City	Spring	County	Montgomery	State	TX
Lender/Client	JoAnne Johnson				
				Zip Code	77381

TOTAL Sketch by a la mode

Area Calculations Summary

Living Area	Area	Calculation Details
First Floor	2236.2 Sq ft	$25 \times 7.6 = 190$ $52.8 \times 28.8 = 1520.6$ $4.4 \times 5 = 22$ $17.1 \times 13 = 222.3$ $14.5 \times 19.4 = 281.3$
Second Floor	2165.6 Sq ft	$10 \times 6.3 = 63$ $13 \times 12.7 = 165.1$ $27.2 \times 15.7 = 427$ $43.2 \times 26.4 = 1140.5$ $6.8 \times 0.6 = 4.1$ $11.6 \times 9.6 = 111.4$ $14.4 \times 6.8 = 97.9$ $8.3 \times 17.4 = 144.4$ $2 \times 6.1 = 12.2$
Third Floor	544.4 Sq ft	$4 \times 7 = 28$ $18 \times 1.6 = 28.8$ $30.9 \times 11.3 = 348.5$ $0.5 \times 2.9 \times 0 = 0$ $20.1 \times 4.3 = 86.8$ $0.5 \times 3.7 \times 3.7 = 6.8$ $12.4 \times 3.7 = 45.6$
Total Living Area (Rounded):	4946 Sq ft	
Non-living Area		
Outdoor Half Bath	28.9 Sq ft	$7.6 \times 3.8 = 28.9$
2 Car Attached	526.7 Sq ft	$22.9 \times 23 = 526.7$