

**LEGEND**

- 1. LOT BOUNDARIES
- 2. RIGHT-OF-WAY BOUNDARIES
- 3. EASEMENTS
- 4. CURB
- 5. DRIVE
- 6. SIDEWALK
- 7. DRIVE
- 8. DRIVE
- 9. DRIVE
- 10. DRIVE
- 11. DRIVE
- 12. DRIVE
- 13. DRIVE
- 14. DRIVE
- 15. DRIVE
- 16. DRIVE
- 17. DRIVE
- 18. DRIVE
- 19. DRIVE
- 20. DRIVE
- 21. DRIVE
- 22. DRIVE
- 23. DRIVE
- 24. DRIVE

**CURVE TABLE**

LINE NO.	START	END	CHORD BEARING	CHORD DIST.	ARC DIST.	ANGLE
1	11.747	11.747	N 117°04'56" E	100.00	100.00	90.00
2	11.747	11.747	N 117°04'56" E	100.00	100.00	90.00
3	11.747	11.747	N 117°04'56" E	100.00	100.00	90.00
4	11.747	11.747	N 117°04'56" E	100.00	100.00	90.00
5	11.747	11.747	N 117°04'56" E	100.00	100.00	90.00
6	11.747	11.747	N 117°04'56" E	100.00	100.00	90.00
7	11.747	11.747	N 117°04'56" E	100.00	100.00	90.00
8	11.747	11.747	N 117°04'56" E	100.00	100.00	90.00
9	11.747	11.747	N 117°04'56" E	100.00	100.00	90.00
10	11.747	11.747	N 117°04'56" E	100.00	100.00	90.00
11	11.747	11.747	N 117°04'56" E	100.00	100.00	90.00
12	11.747	11.747	N 117°04'56" E	100.00	100.00	90.00
13	11.747	11.747	N 117°04'56" E	100.00	100.00	90.00
14	11.747	11.747	N 117°04'56" E	100.00	100.00	90.00
15	11.747	11.747	N 117°04'56" E	100.00	100.00	90.00
16	11.747	11.747	N 117°04'56" E	100.00	100.00	90.00
17	11.747	11.747	N 117°04'56" E	100.00	100.00	90.00
18	11.747	11.747	N 117°04'56" E	100.00	100.00	90.00
19	11.747	11.747	N 117°04'56" E	100.00	100.00	90.00
20	11.747	11.747	N 117°04'56" E	100.00	100.00	90.00
21	11.747	11.747	N 117°04'56" E	100.00	100.00	90.00
22	11.747	11.747	N 117°04'56" E	100.00	100.00	90.00
23	11.747	11.747	N 117°04'56" E	100.00	100.00	90.00
24	11.747	11.747	N 117°04'56" E	100.00	100.00	90.00

**MINIMUM SLAB TABLE**

BLOCK	LOT	MINIMUM SLAB ELEVATION	MINIMUM FINISH FLOOR ELEVATION
1	1-20	66.97 FEET	66.97 FEET
2	21-24	66.97 FEET	66.97 FEET
3	25-28	66.97 FEET	66.97 FEET
4	29-32	66.97 FEET	66.97 FEET
5	33-36	66.97 FEET	66.97 FEET
6	37-40	66.97 FEET	66.97 FEET
7	41-44	66.97 FEET	66.97 FEET
8	45-48	66.97 FEET	66.97 FEET
9	49-52	66.97 FEET	66.97 FEET
10	53-56	66.97 FEET	66.97 FEET
11	57-60	66.97 FEET	66.97 FEET
12	61-64	66.97 FEET	66.97 FEET
13	65-68	66.97 FEET	66.97 FEET
14	69-72	66.97 FEET	66.97 FEET
15	73-76	66.97 FEET	66.97 FEET
16	77-80	66.97 FEET	66.97 FEET
17	81-84	66.97 FEET	66.97 FEET
18	85-88	66.97 FEET	66.97 FEET
19	89-92	66.97 FEET	66.97 FEET
20	93-96	66.97 FEET	66.97 FEET
21	97-100	66.97 FEET	66.97 FEET

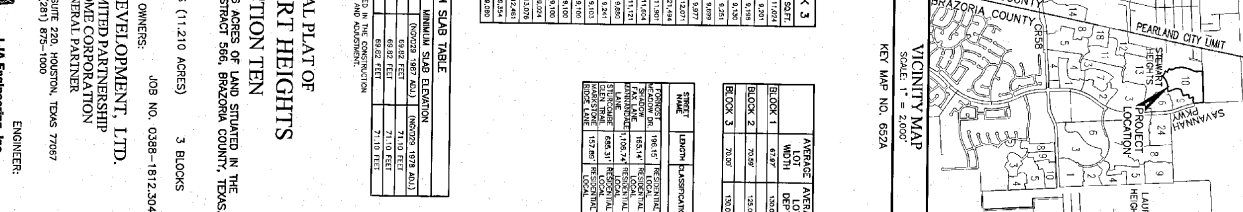

**FINAL PLAT OF 26.38 ACRES OF LAND SITUATED IN THE STEWART HEIGHTS SECTION TEN**

A SUBDIVISION OF 26.38 ACRES OF LAND SITUATED IN THE J. S. TAMMAGE SURVEY, ABSTRACT 566, BRAZORIA COUNTY, TEXAS.

48 LOTS 3 RESERVES (11.210 ACRES) 3 BLOCKS

OWNERS: JOB NO. 0288-1812.304

SAVANNAH DEVELOPMENT, LTD.  
ATEXAS LIMITED PARTNERSHIP  
BY: U.S. HOME CORPORATION  
ITS GENERAL PARTNER  
681 GREENS PARKWAY, SUITE 220 HOUSTON, TEXAS 77067  
PH: (281) 679-1000

ENGINEER: LIA Engineering, Inc.  
32001 Sam Houston Parkway S., Suite 600, Houston, Texas 77062  
Phone: 713.633.4200  
Fax: 713.633.4208  
T9911.E (REV. 10/15/02)

DATE: AUGUST 18, 2020

SCALE: 1" = 100'

SCALE: 1" = 2000'

KEY MAP NO. 6524

DATE: 11/18/2020

PROJECT: STEWART HEIGHTS 10.LP.DWG

CHECK: SURV C.C. 9/24

