

SCALE
1"=20'



NOTES:

- Survey bases on the best field evidence found.
- Bearings shown hereon are based on the control monuments depicted within the survey.
- Property subject to other subdivision covenants, conditions & restrictions be easements, building lines and other matters of record.

ABSTRACTING NOTES:

Survey was performed without the benefit of a current Title Report at the client's request. There may be other easements and encumbrances that affect Subject property that are not shown.

| | | | | |
|--|-------------------|--|----------------------|--|
| LOT(S): 16 | BLOCK: 6 | SUBDIVISION: MEMORIAL HOLLOW, SECTION 4 | | |
| RECORDATION: VOL. 75, PG. 48, H.C.M.R | COUNTY: HARRIS | STATE: TEXAS | SURVEY: FORM | |
| ADDRESS: 12231 KIMBERLEY LANE | | CITY: HOUSTON, 77024 | EFFECTIVE DATE: - | |
| PURCHASER: - | | TITLE COMPANY: - | GF. No. - | |

I DO HEREBY CERTIFY THAT THIS SURVEY WAS MADE ON THE GROUND FOR THE PROPERTY LEGALLY DESCRIBED HEREON (OR ON ATTACHED SHEET) REPRESENTS THE FACTS FOUND AT THIS TIME.

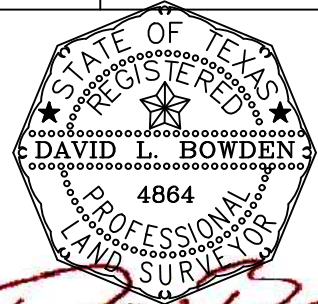

David L. Bowden TX. R.P.L.S. No. 4864

THIS PROPERTY IS NOT IN THE 100 YEAR FLOOD ZONE, IS IN ZONE X PER F.I.R.M. MAP No. 48201C0645L
 DATED: 06/18/2007



Bowden Survey

PROFESSIONAL SURVEYING SERVICES

bowdensurvey.com

HOUSTON, TEXAS 77077

PHONE: (281) 531-1900 FAX: (281) 531-4900

TBPLS Registration No. 10127400

| | | |
|-------------|------------|------------|
| FIELD WORK | GT | 06.26.2025 |
| DRAFTED BY | GT | 07.10.2025 |
| JOB No. | GT25 - 249 | |
| KEY MAP No. | - | |