

ACREAGE
THE WOODLANDS
DEVELOPMENT COMPANY, L.P.
M.C.R.P.R. FILE NO. 9747722

NOTES:

- 1.) SUBJECT TO RESTRICTIVE COVENANTS RECORDED UNDER M.C.C.F. NOS. 9348561, 2002-037187, 2002-037186, 2002-069797, 2000-00528, 2000-065606 AND 2003-005072 AND CABINET R, SHEET 114 OF M.C.M.R.
- 2) SUBJECT TO CITY ZONING ORDINANCES AND RESTRICTIONS IF ANY.
- 3) 10' (FRONT/REAR) & 5' (SIDES) UTILITY ESMTS BY M.C.C.F. NO. 9348561.
- 4) THE SUBJECT PROPERTY LIES WITHIN THE BOUNDARIES OF MONTGOMERY COUNTY MUNICIPAL UTILITY DISTRICT NO. 39.
- 5) ALL ELEVATIONS SHOWN HEREON ARE TOP-OF-FORM AND BASED ON TBM FOUND. A 2" BRASS DISK FOUND AT GUTTER OF MEDIAN OF ROLLING RIDGE COURT, ELEVATION=123.39'.
- 6.) -//- DENOTES WOODEN FENCE.

BUYER'S ACKNOWLEDGMENT

THIS SURVEY IS NOT TO BE USED FOR FUTURE CONSTRUCTION PURPOSES. ALL BEARINGS ARE BASED ON THE RECORDED PLAT UNLESS OTHERWISE NOTED. FLOOD ZONE DETERMINED BY GRAPHIC PLOTTING ONLY. WE DO NOT ASSUME RESPONSIBILITY FOR EXACT DETERMINATION. THIS SURVEY HAS BEEN PREPARED FROM INFORMATION CONTAINED IN THE TITLE COMMITMENT REFERENCED IN GF NO.03005756-333, ONLY.

LOT 42	BLOCK 1	SECTION 11	SUBDIVISION THE WOODLANDS HARPER'S LANDING AT COLLEGE PARK		FLOOD NOTE THIS TRACT IS LOCATED WITHIN FLOOD ZONE "X" (UNSHADED) ACCORDING TO THE FEDERAL EMERGENCY MANAGEMENT AGENCY (FEMA) FLOOD INSURANCE RATE MAP (FIRM) COMMUNITY PANEL NO. 480483 0529F , REVISED DECEMBER 19, 1996 .
RECORDATION CABINET R, SHEET 114, OF M.C.M.R		COUNTY MONTGOMERY	STATE TEXAS	SURVEY RICHARD VINCE SURVEY A-583	
LENDER CO. RYLAND MORTGAGE COMPANY		TITLE CO. RYLAND TITLE COMPANY			
PURCHASER MOISES BLOUSMAN AND MARIA BLOUSMAN					JOB NO. RY1971
ADDRESS 123 GENESEE RIDGE DRIVE					

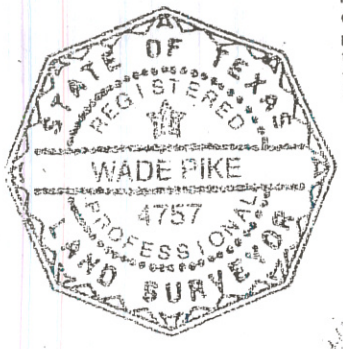
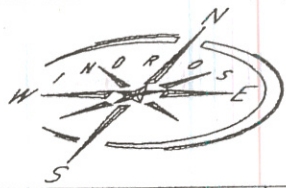

I do hereby certify that this survey under my supervision was this day made on the ground and that this plat correctly represents the property legally described hereon (or on attached sheet). That the facts found at the time of this survey show the improvements and that there are no visible encroachments apparent on the ground, except as shown, to the best of my knowledge.

FIELD WORK	09-27-03	DG
DRAFTED BY	09-30-03	PC
CHECKED BY	09-30-03	WP
KEY MAP NO.	218K-P	

REVISION		
-	-	-
-	-	-

Windrose Land Services, Inc.
10675 Richmond Ave.
Houston, Texas 77042
Phone (713) 458-2282 Fax (713) 461-1151

**Professional Surveying
and Engineering Services**