

- LEGEND:
- ALUM = ALUMINUM
  - ATT PH = ATT PULLHOLE
  - BC = BOX CULVERT
  - B.L. = BUILDING LINE
  - BLDG = BUILDING
  - BWF = BARR WIRE FENCE
  - C = CONCRETE
  - CRB = CINDER BLOCK BUILDING
  - CLF = CHAIN LINK FENCE
  - CLV = CULVERT
  - CM = CABLE MARKER
  - CONC. MON. = CONCRETE MONUMENT
  - DE = DRAINAGE EASEMENT
  - DG = DOWN GUY
  - D.R.M.C. = DEED RECORDS OF MONTGOMERY COUNTY
  - FB = FIBERGLASS BUILDING
  - FND = FOUND
  - FDCM = FIBER OPTIC CABLE MARKER
  - FP = FLAG POLE
  - GAR = GARAGE
  - GP = GATE POST
  - GR = GRAVEL
  - GRM = GRAVEL MOUND
  - GRV = GRAVEL
  - C.S.U.C. = GULF STATES UTILITIES COMPANY
  - HW = HEADWALL
  - HWF = HOG WIRE FENCE
  - I.R.C. = IRON ROD WITH CAP
  - I.R. = IRON ROD
  - I.P. = IRON PIPE
  - L.E. = LANDSCAPE EASEMENT
  - M.C.C.F. = MONTGOMERY COUNTY CLERK'S FILE
  - MH = MANHOLE
  - ML = METAL LID
  - MP = METER POLE
  - M.R.M.C. = MAP RECORDS OF MONTGOMERY COUNTY
  - POB = POINT OF BEGINNING
  - PP = POWER POLE
  - RES = RESIDENCE
  - SGN = SIGN
  - SP = SERVICE POLE
  - ST = STAIRS
  - TP = TELEPHONE PEDESTAL
  - T.S.B. = TRAFFIC SIGNAL BOX
  - T.S.P. = TRAFFIC SIGNAL POLE
  - TxDOT = TEXAS DEPARTMENT OF TRANSPORTATION
  - U.E. = UTILITY EASEMENT
  - UCCM = UNDERGROUND CABLE MARKER
  - VF = VINYL FENCE
  - WD = WOOD DECK
  - WF = WOOD FENCE



- NOTES:
1. This survey was performed without the benefit of a current title report therefore all easements and other matters of record which may have been granted may not be shown hereon.
  2. Bearing orientation based on Texas State Plane Coordinate Grid System of 1983 (Central Zone No. 4203). Derived from CORS site CDMS.
  3. Surveyor did not abstract tract.
  4. ( ) indicates deed or plot call.
  5. Subject to Restrictive Covenants as set out under M.C.C.F. No(s) 9050368, 9780414, 9782449, 2009-073913, 2014-092128, 2015-015995 and 2015-066713.
  6. Based on graphical plotting no portion of these tract lies within a "100 year flood hazard area" as designated on the National Flood Insurance Program - Flood Insurance Rate Map issued by the Federal Emergency Management Agency under Community Panel Number 480483 0500 G for Montgomery County, Texas, dated August 18, 2014. The "100 year flood hazard area" is subject to change as detailed studies become available and/or watershed or channel conditions change.
  7. Access easement granted to East Montgomery County Municipal Utility District No. 4 in instrument executed by Robin Hood Sherwood Partners, L.P., dated February 7, 2008, recorded under M.C.C.F. No. 2008-013562, does not affect the subject tracts.
  8. Subject to terms, conditions and provisions as set out in Danielson right-of-way deeds from Roland McReynolds, Trustee, to the State of Texas, recorded under M.C.C.F. Nos. 9050368, 9780414 and 9782449.
  9. Subject to terms, conditions and provisions of that certain Declaration of Covenant recorded under M.C.C.F. Nos. 2009-073913, 2011-073422, 2011-108025 and 2012-006280.
  10. Subject to terms, conditions and provisions of that certain Declaration of Easements and Restrictions recorded under M.C.C.F. Nos. 2015066713.
  11. Subject to covenants, conditions and restrictions recorded under 2009-073913, 2011-073422, 2011-108025 and 2012-006280.
  12. Tract being more particularly described by separate maps and bounds. See HSC file numbers 813-035.000, J13-035.000, KKK13-035.000 and L113-035.000.

LINE	DISTANCE	BEARING
L1	245.66'	S 45°28'14" E
L2	245.69'	S 78°45'37" E
L3	590.35'	S 01°49'46" E
L4	396.21'	N 88°27'40" E
L5	396.21'	S 86°27'40" W

CURVE	RADIUS	DELTA	ARC	TANGENT	BEARING	CHORD
C1	5193.85	0°3'14"17"	293.52	146.80	S 43°39'49" E	293.48
C2	5198.85	2°7'05"00"	2457.45	1252.13	S 61°31'57" E	2434.64
C3	5188.85	0°7'13"39"	654.53	327.70	S 81°23'46" E	654.10
C4	3960.00	0°8'40"09"	599.17	300.16	S 86°18'48" E	598.60
C5	5188.85	0°6'35"43"	597.28	298.97	N 88°18'27" W	598.95
C6	3960.00	0°2'53"28"	199.82	99.93	N 87°54'24" E	199.79
C7	5188.85	0°1'26"13"	130.13	65.07	S 87°40'35" W	130.12
C8	3960.00	0°8'40"09"	599.17	300.16	N 86°18'48" W	598.60
C9	3960.00	0°2'53"28"	199.82	99.93	S 87°54'24" W	199.79

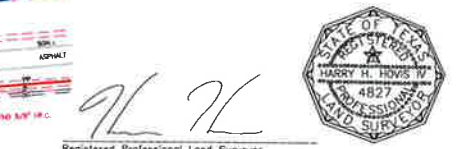

**HSC HOVIS SURVEYING COMPANY**

Land Surveys - Computer Mapping  
 5000 Cabbage - Spring, Texas 77379  
 (281) 320-9591  
 Accege - Residential - Industrial - Commercial  
 Texas Firm Registration No. 10030400

EXHIBIT SHOWING 8.192 ACRES (SPORTSPLEX "A-1"), 8.070 ACRES (SPORTSPLEX "B-1"), 12.854 ACRES (SPORTSPLEX "A-2") AND 13.336 ACRES (SPORTSPLEX "B-2") OF LAND SITUATED IN THE HENRY A. PETERS SURVEY, ABSTRACT NUMBER 434, MONTGOMERY COUNTY, TEXAS.

DATE: FEBRUARY 26, 2018 SCALE: 1" = 200' JOB NO. 13-035-00

HSC 02579-E  
1303500CC.DWG